

Rev.E Mar.-2016

TO-220S

Schottky diode in a TO-220S Plastic Package.

Low power loss, high efficiency.

For high frequency, high voltage, high current rectifier diode, freewheeling diode.

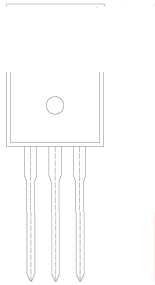
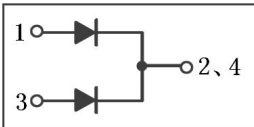

PIN1 Anode

PIN 2 Cathode

PIN 3 Anode

PIN 4 NC

See Marking Instructions.

Parameter	Symbol	Rating	Unit
Peak Repetitive Reverse Voltage Working Peak Reverse Voltage Reverse Voltage	V_{RRM} V_{RWM} V_{RM}	150	V
RMS Reverse Voltage	$V_{R(RMS)}$	105	V
Average Rectified Forward Current	$I_{F(AV)}$	2*5	A
Non Repetitive Peak Surge Current	I_{FSM}	100	A
Thermal Resistance Junction to Case	R_{Jc}	3.5	/W
Junction Temperature Range	T_{jMAX}	150	
Storage Temperature Range	T_{stg}	-65 150	

Parameter	Symbol	Test Conditions	Min	Typ	Max	Unit
Reverse Voltage	$V_{(BR)R}$	$I_R=0.3mA$	150			V
Forward Voltage	V_F	$I_F=5A$ $T_j=25$			0.85	V
		$I_F=5A$ $T_j=125$			0.70	V

s

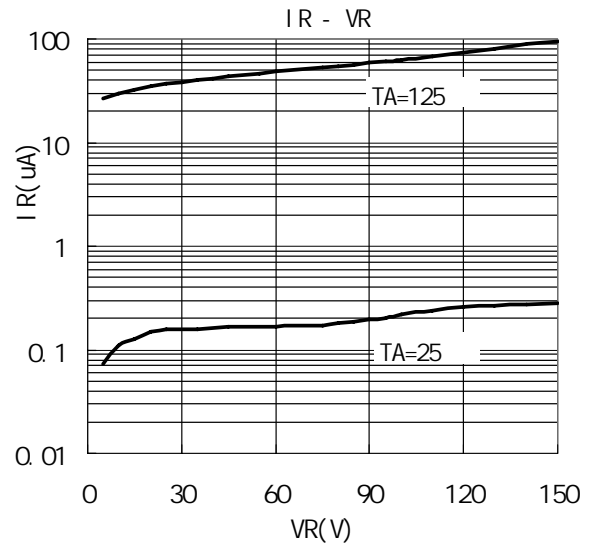
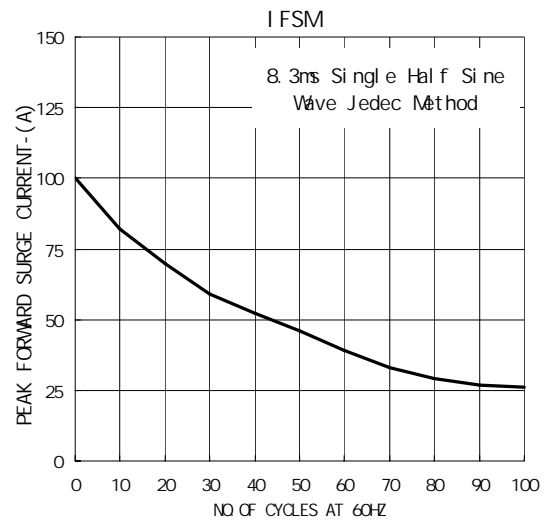
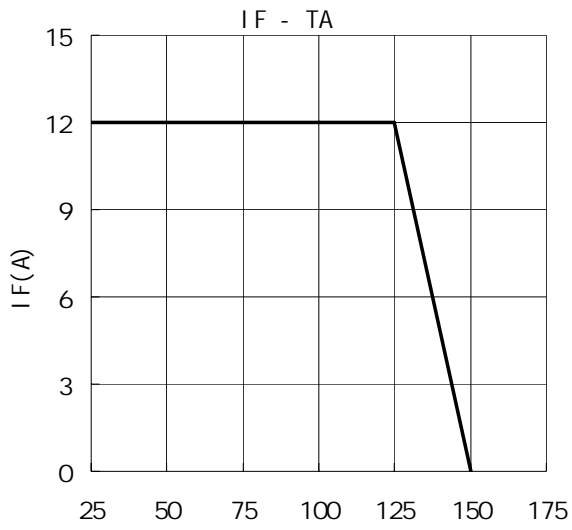

TO-220S

Unit: mm

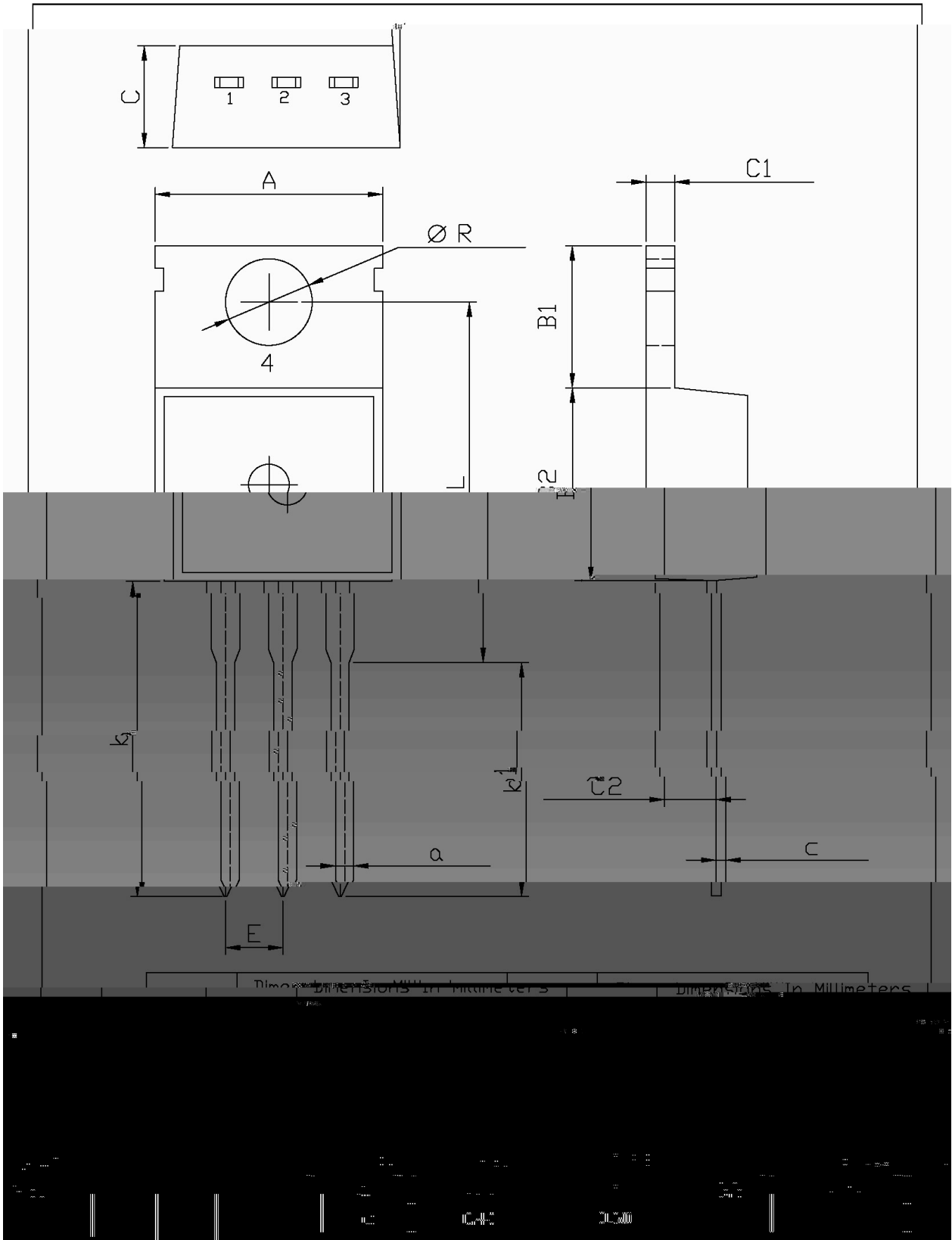

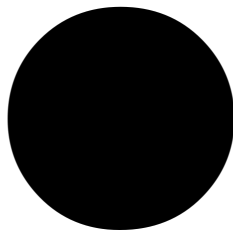
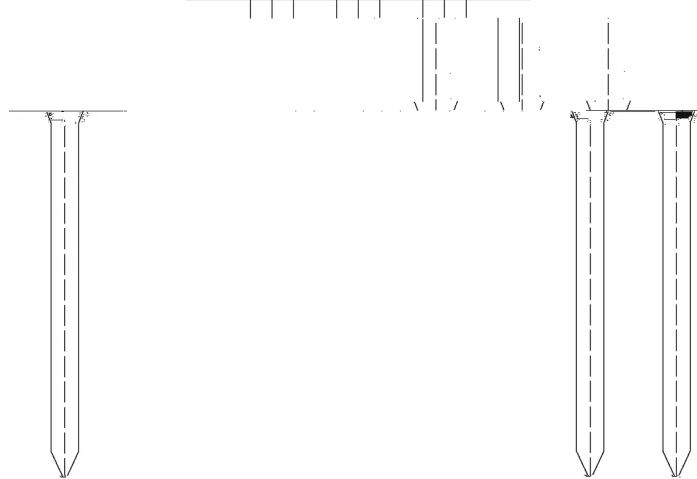
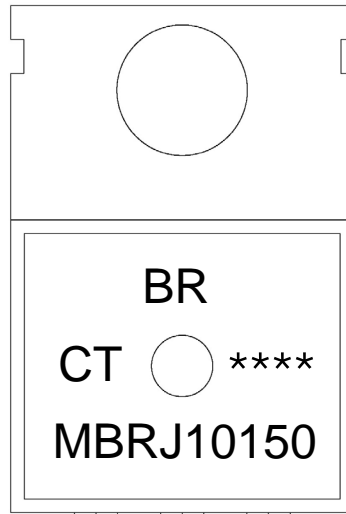

Note:

BR:

Company Code

MBRJ10150

Product Type.

CT:

Internal Structure

****:

Lot No. Code, code change with Lot No.

