

KTC3879S

Rev.F Apr.-2017

/ Descriptions

SOT-23

NPN

Silicon NPN transistor in a SOT-23 Plastic Package.

/ Features

High G_{pe} .

/ Applications

HF,VHF band amplifier application.

/ Equivalent Circuit

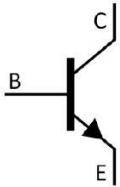

/ Pinning



PIN 1 Base

PIN 2 Emitter

PIN 3 Collector

/ h_{FE} Classifications & Marking

h_{FE} Classifications Symbol	R	O	Y
h_{FE} Range	40 80	70 140	120 240
Marking	HRR	HRO	HRY

Parameter	Symbol	Rating	Unit
Collector to Base Voltage	V_{CBO}	35	V
Collector to Emitter Voltage	V_{CEO}	30	V
Emitter to Base Voltage	V_{EBO}	4.0	V
Collector Current	I_C	50	mA

peratCurgrge 50

/ Electrical Characteristic Curve

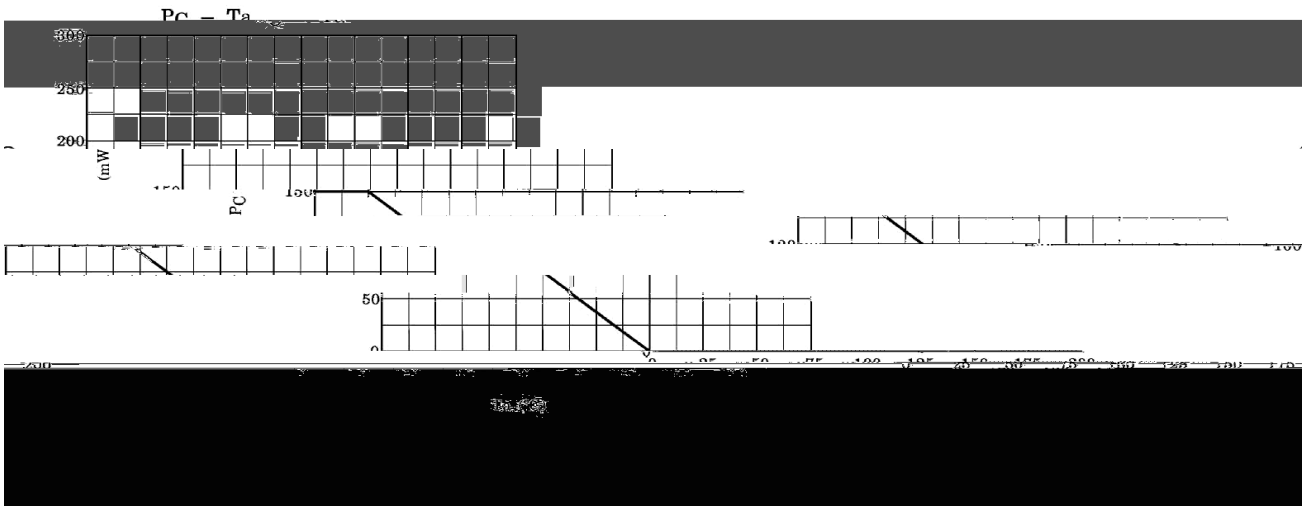
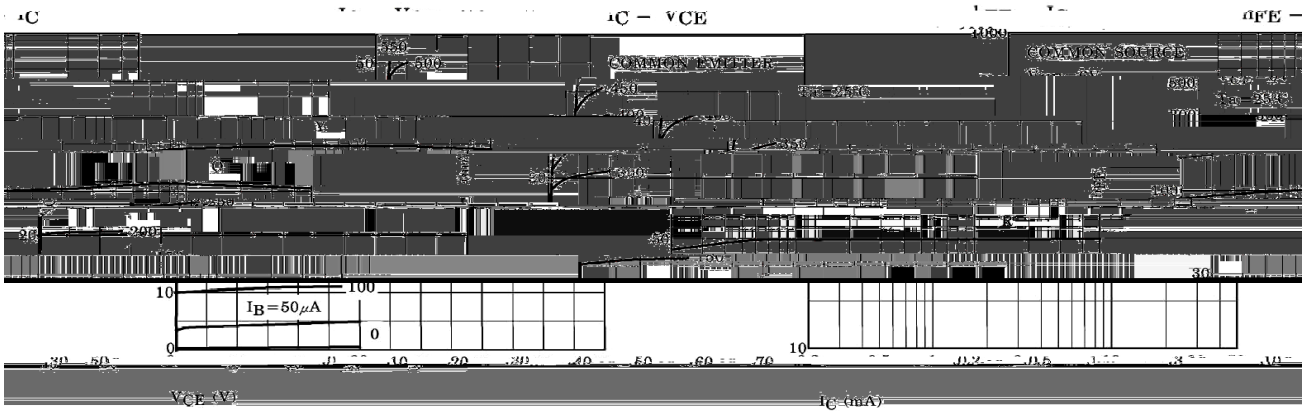

/ Package Dimensions

SOT-23

单位: mm

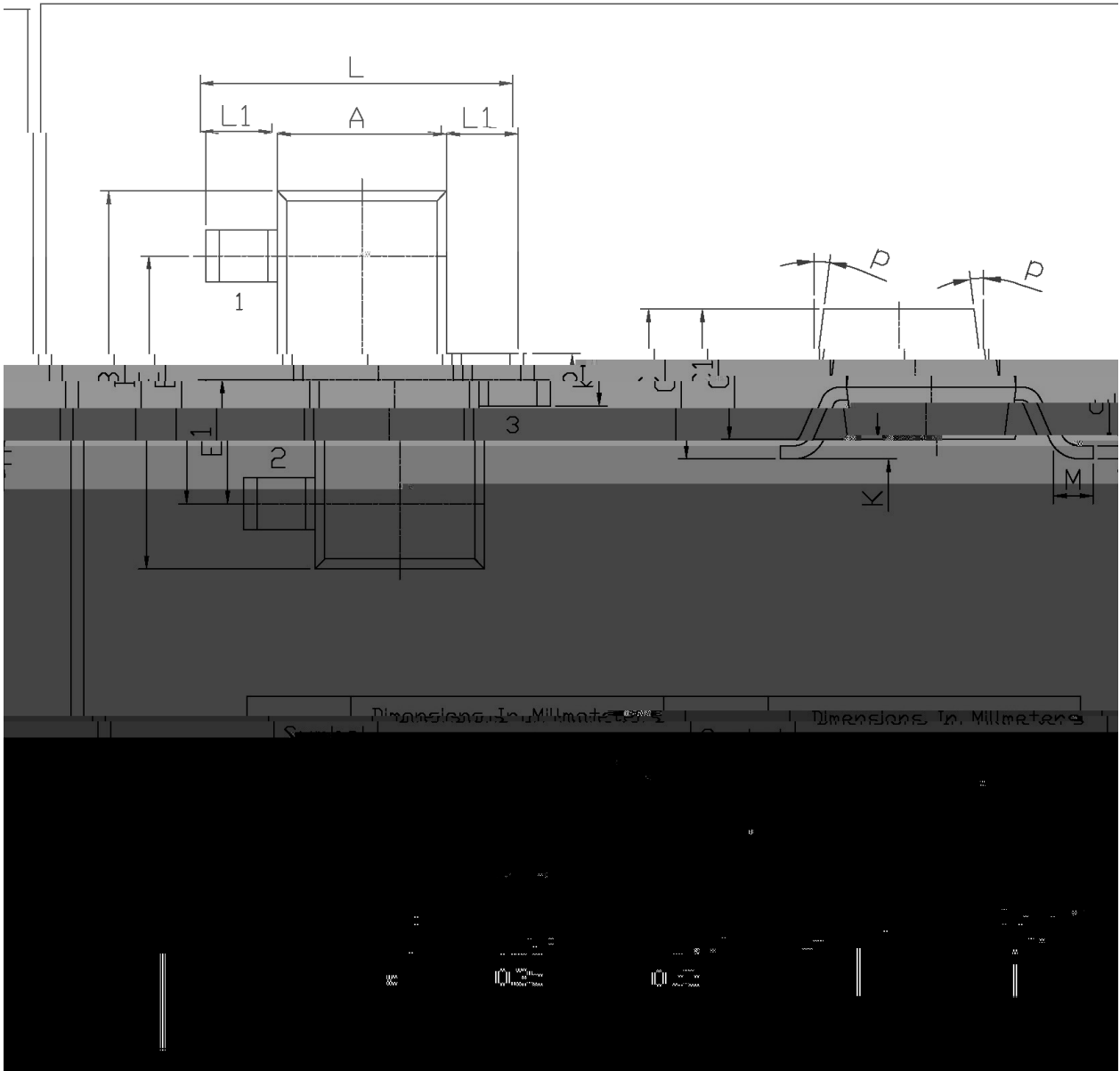

/ Marking Instructions

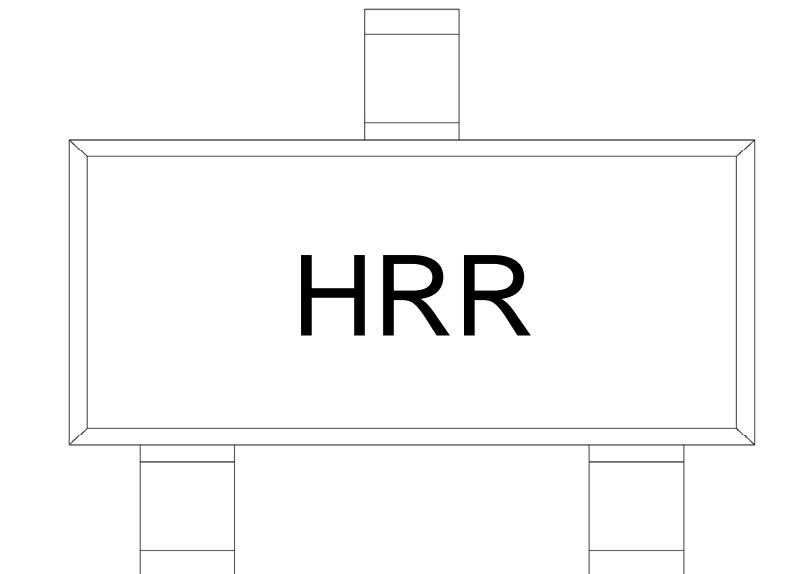

H

R

R h_{FE}

Note:

H Company Code

R Product Type

R h_{FE} Classifications Symbol

() / Temperature Profile for IR Reflow Soldering(Pb-Free)

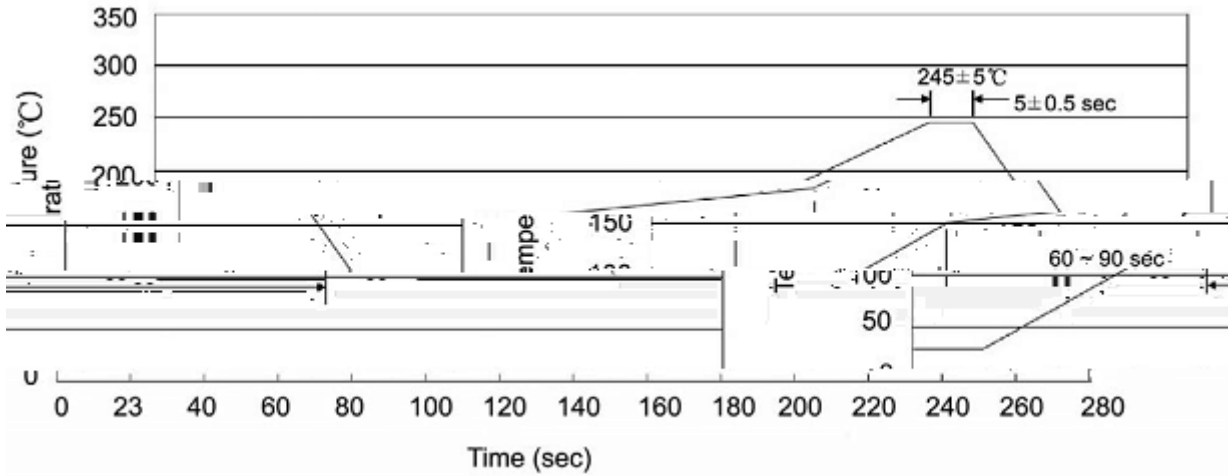

Note:

- | | | | | | |
|---|-------|-----|-----------|--------|---|
| 1 | 25 | 150 | 60 | 90sec; | 1.Preheating:25~150 , Time:60~90sec. |
| 2 | 245±5 | | 5±0.5sec; | | 2.Peak Temp.:245±5 , Duration:5±0.5sec. |
| 3 | | 2 | 10 | /sec. | 3. Cooling Speed: 2~10 /sec. |

/ Resistance to Soldering Heat Test Conditions

260±5 10±1 sec. Temp.:260±5 Time:10±1 sec

/ Packaging SPEC.

/ REEL

Package Type	Units					Dimension (unit mm ³)		
	Units/Reel	Reels/Inner Box	Units/Inner Box	Inner Boxes/Outer Box	Units/Outer Box	Reel	Inner Box	Outer Box
SOT-23	3,000	10	30,000	6	180,000	7 ×8	180×120×180	390×385×205