

/ Descriptions

KF \$() - = E GE

/ Features

/ Applications

%

/ Equivalent Circuit

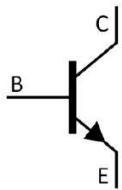

/ Pinning

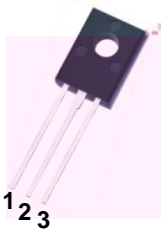

/ h_{FE} Classifications & Marking

KSE180

/ Electrical Characteristic Curve

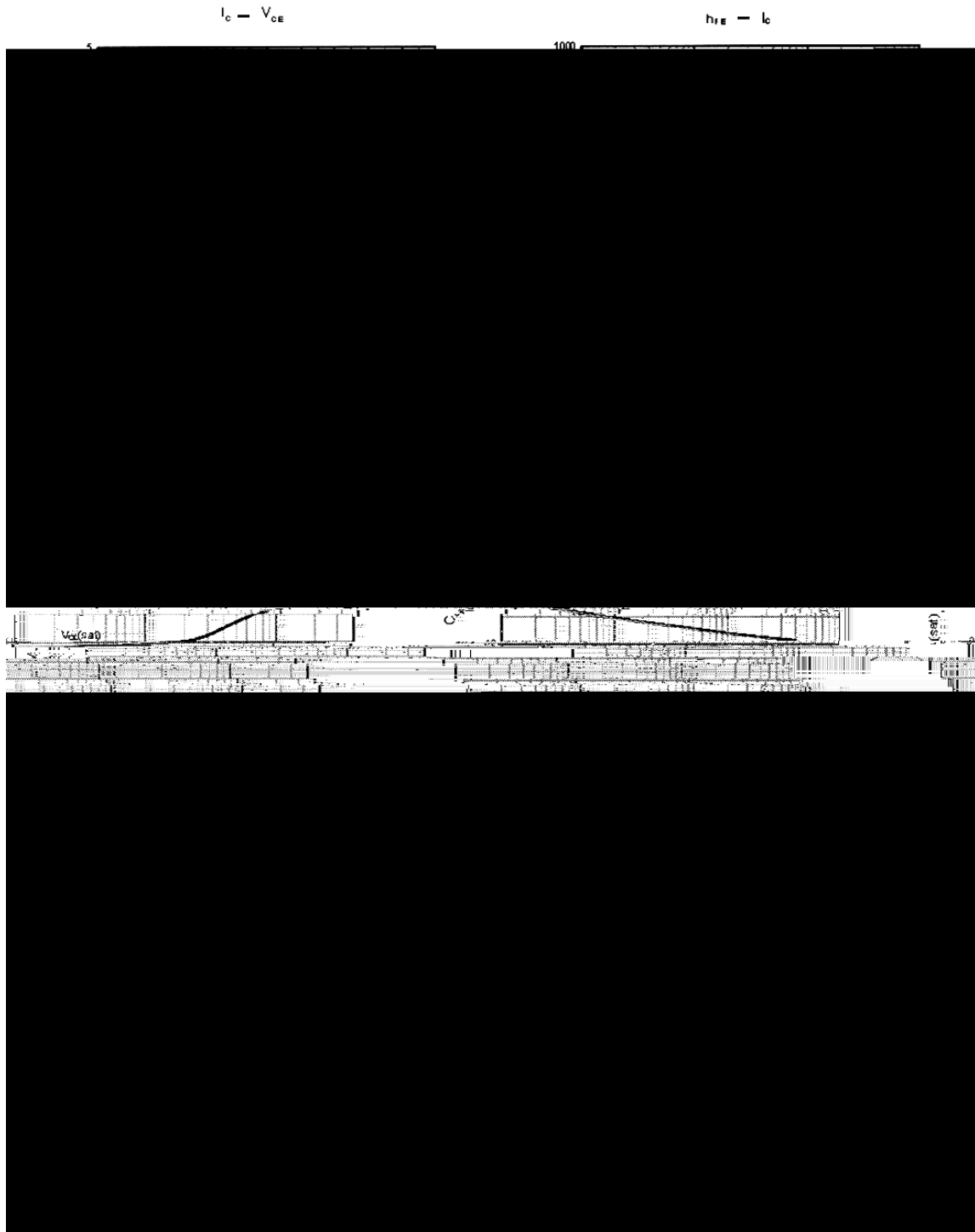

/ Package Dimensions

10-1261

单位: mm

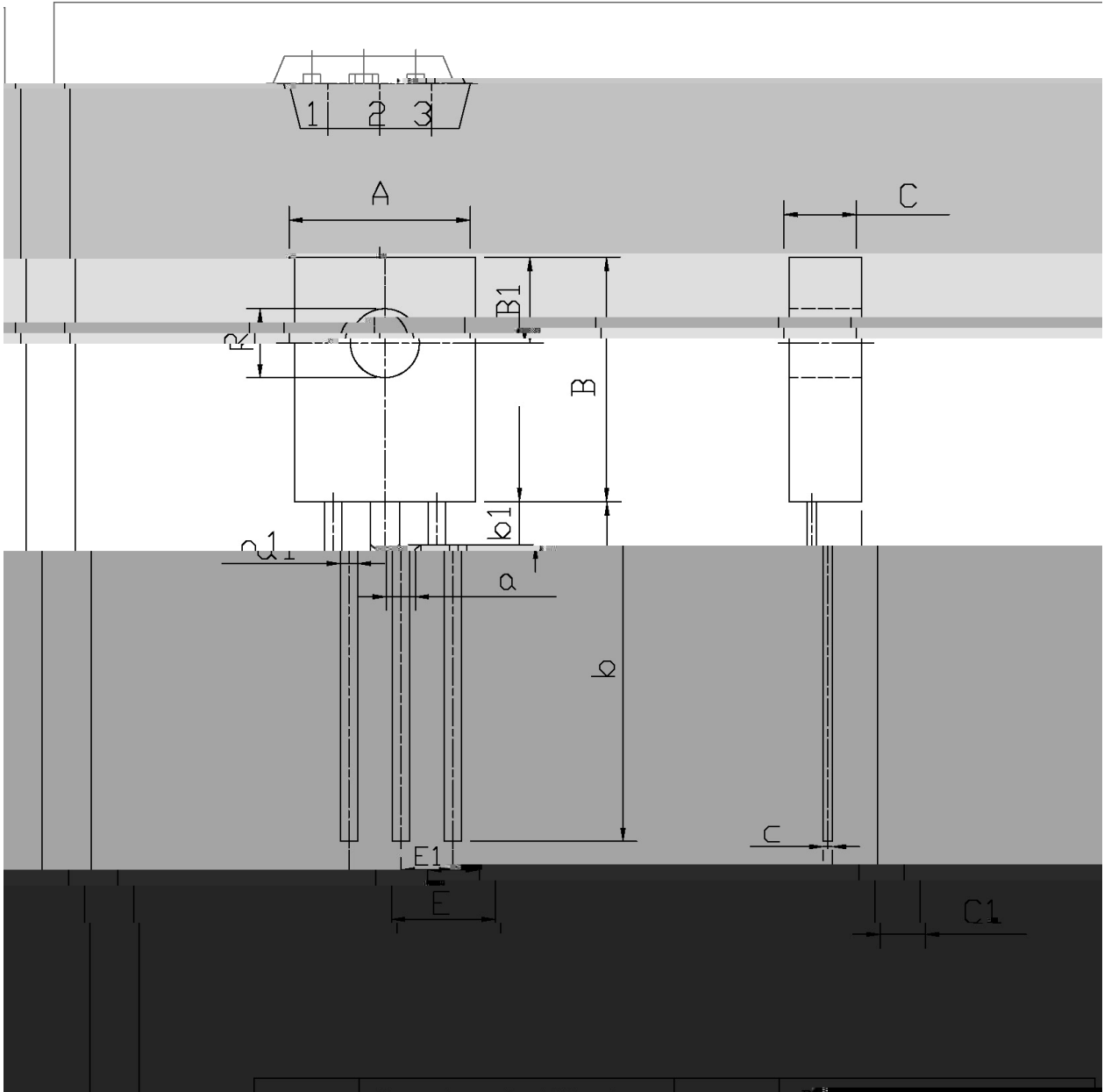

Dimensions in millimeters (mm)		Symbol		Dimensions in millimeters (mm)		Symbol	
Max	Min	Max	Min	Max	Min	Max	Min
0.86		A	7.8	8.2	a1	0.66	

KSE180

() / Temperature Profile for Dip Soldering(Pb-Free)

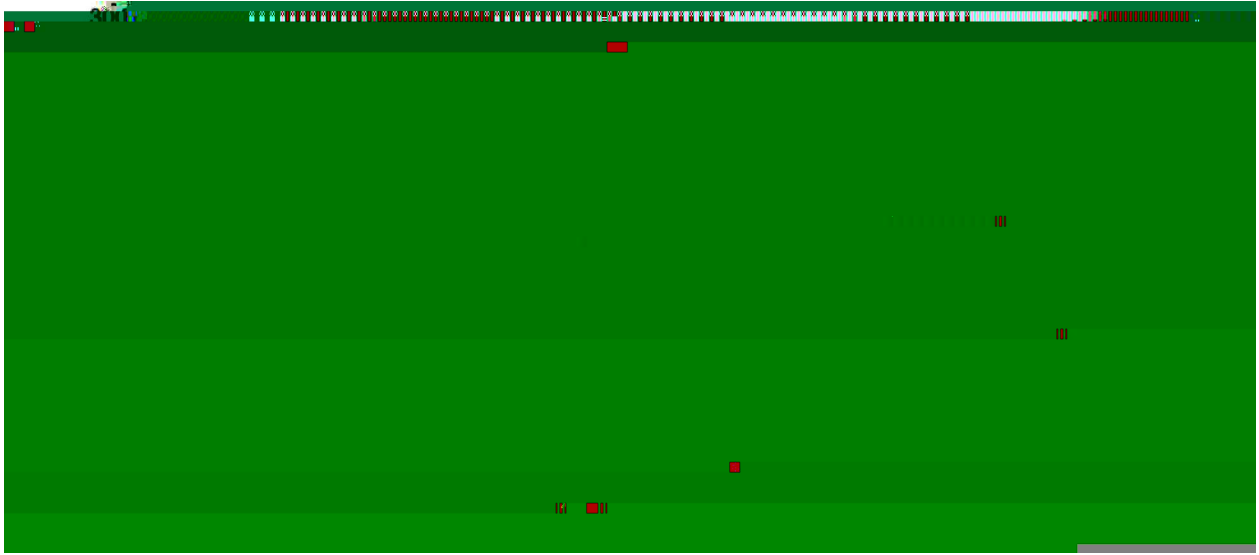

... ..

/ Resistance to Soldering Heat Test Conditions

... ..

/ Packaging SPEC.

						Tube	Inner Box	Outer Box
	Units/Tube /	Tubes/Inner Box /	Units/Inner Box /	Inner Boxes/Outer Box /	Units/Outer Box /			
TO-126/F	500	6	3,000	5	15,000	135×190	237×172×102	560×245×195
