

BRMBR30200CTRA

Rev. B Jul.-2018

TO-220

Schottky Barrier Diode in a TO-220 Plastic Package.

Low power loss, high efficiency.

For use in low voltage, high frequency inverters, free wheeling, and polarity protection applications.



PIN1 Anode

PIN 2 Cathode

PIN 3 Anode

/ h_{FE} Classifications & Marking

See Marking Instructions

BRMBR30200CTRA

Rev. B Jul.-2018

Parameter	Symbol	Rating	Unit
Peak Repetitive Reverse Voltage	V_{RRM}	200	V
Working Peak Reverse Voltage	V_{RWM}	200	V
Average Rectified Forward Current	$I_{F(AV)}$	15	A
	$I_{F(AV) \text{ total}}$	30	A
Non-Repetitive Peak Forward Surge Current	I_{FSM}	320	A
Thermal Resistance Junction to Case	R_{JC}	2.2	/W
Junction Temperature Range	T_j	175	
Storage Temperature Range	T_{stg}	-40 175	

Parameter	Symbol	Test Conditions	Min	Typ	Max	Unit	
Reverse Voltage	$V_{BR R}$	$I_R=1mA(T_a=25^\circ C)$	200			V	
Forward Voltage	V_F	$I_F=15A(T_a=25^\circ C)$		0.86	0.92	V	
		$I_F=15A(T_a=125^\circ C)$			0.78	V	
		$I_F=20A(T_a=25^\circ C)$		0.89	0.95	V	
		$I_F=20A(T_a=125^\circ C)$			0.82	V	
		$I_F=200V(T_a=25^\circ C)$				100	uA
		$I_F=200V(T_a=125^\circ C)$				5	mA

/ Electrical Characteristic Curve

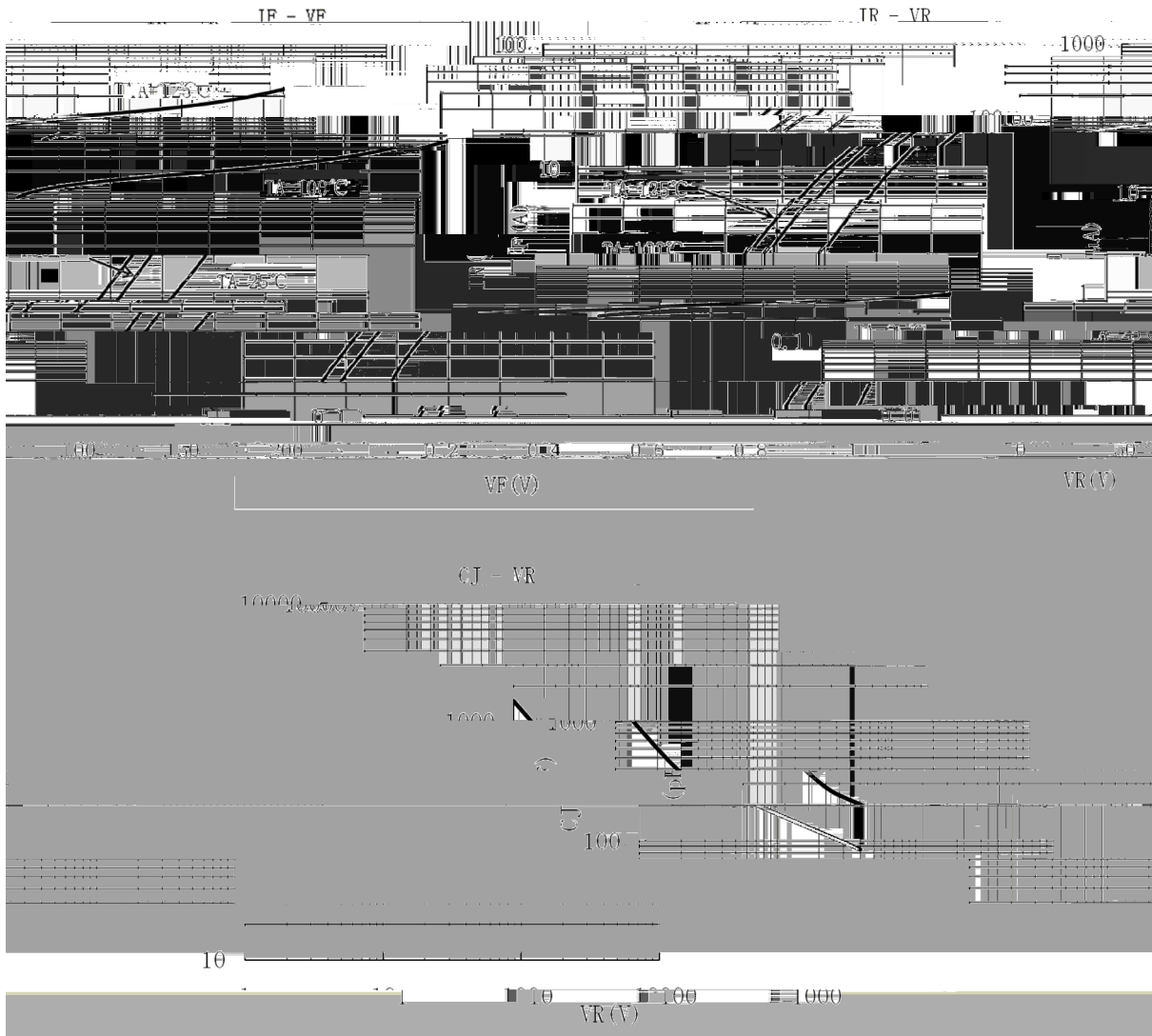
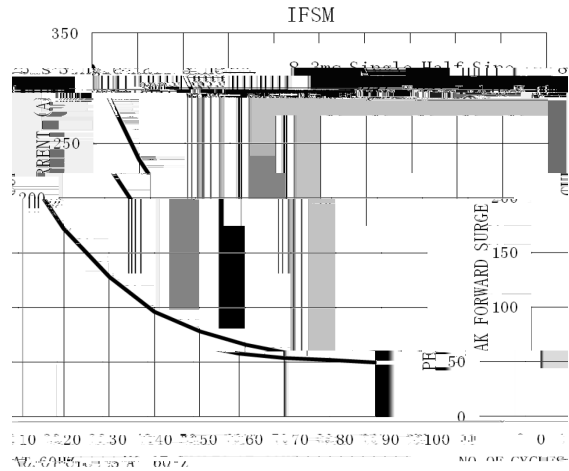
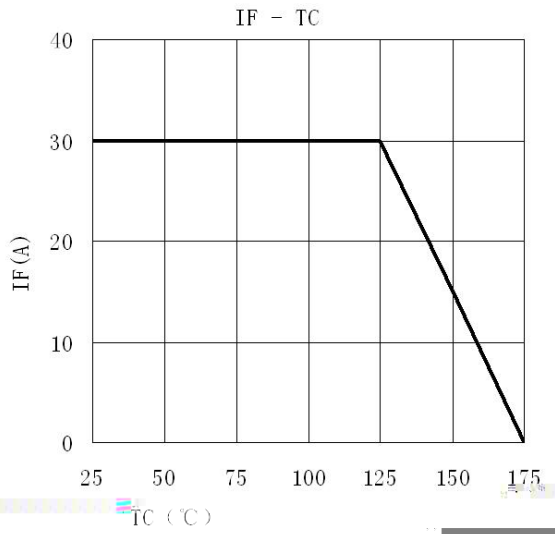

/ Package Dimensions

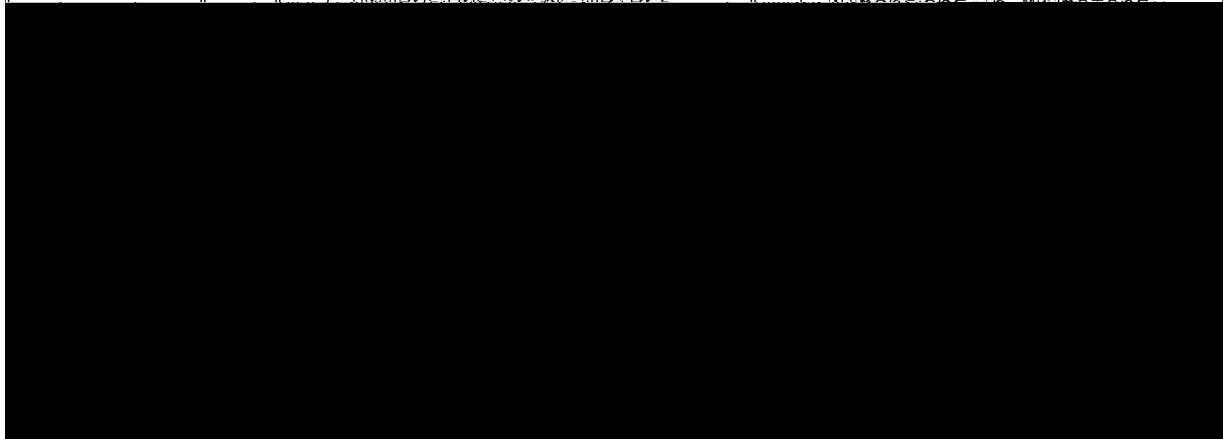
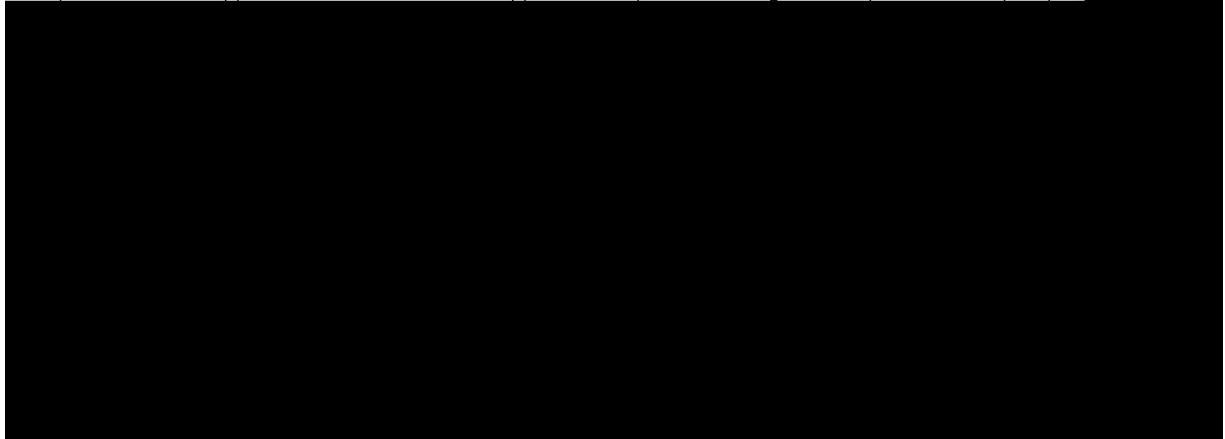
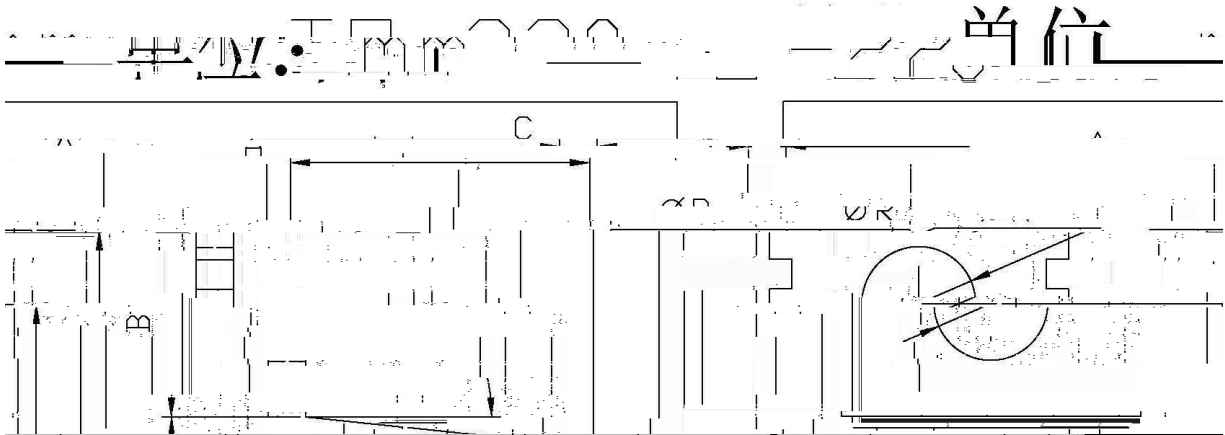

/ Marking Instructions

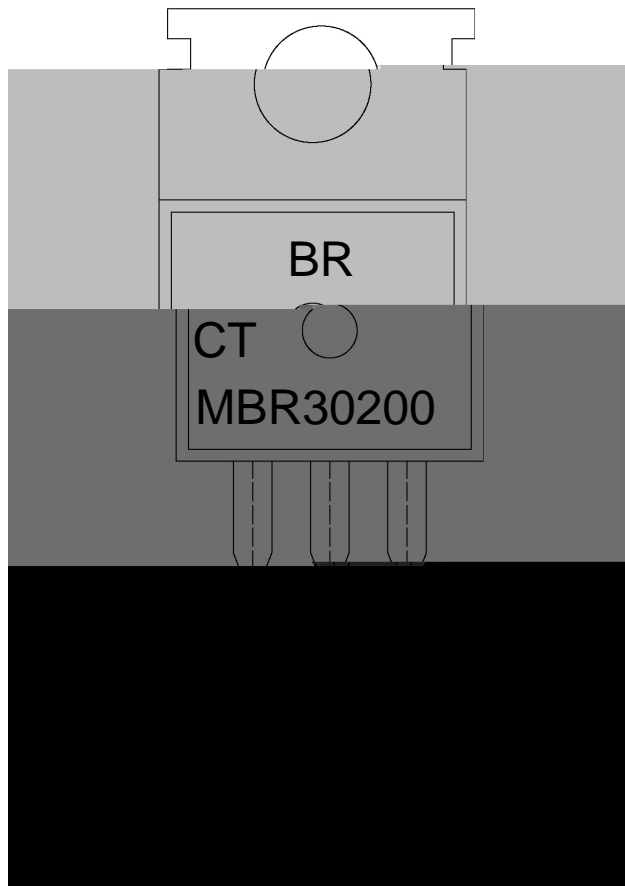

BR

MBR30200

CT:

Note:

BR: Company Code

MBR30200 Product Type.

CT: Internal Structure

****: Lot No. Code, code change with Lot No.

() / Temperature Profile for Dip Soldering(Pb-Free)

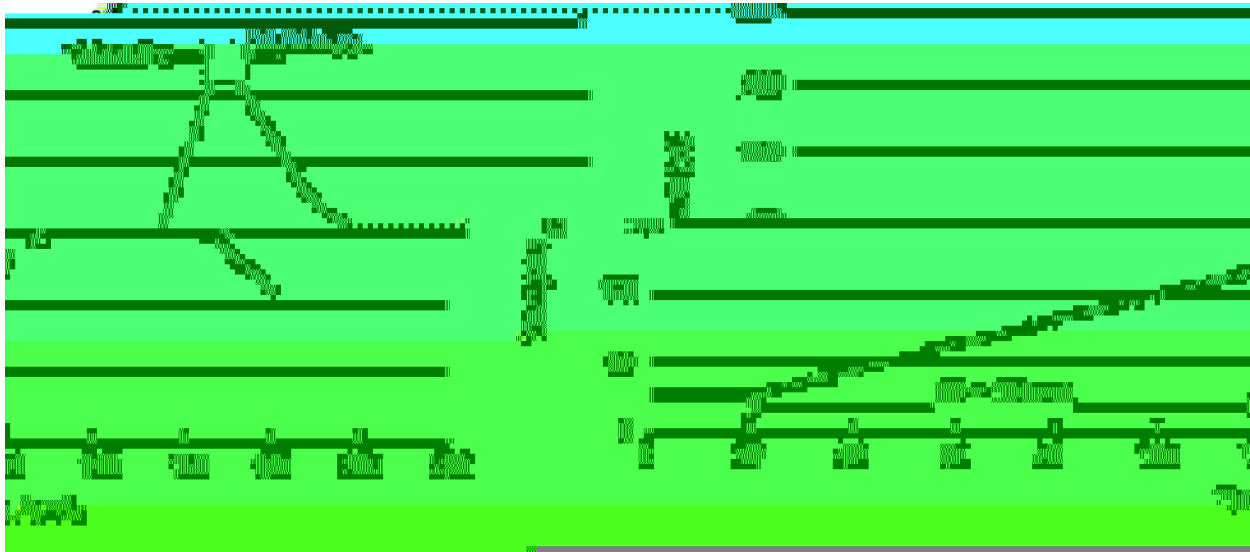

Note:

1

25