

BRCS4614YAQ

BRCS4614YAQ

Rev.A May.-2023



DATA SHEET

Parameter	Symbol	Rating		Unit
		N-channe	P-channell	
Drain-Source Voltage	V_{DSS}	± 40		V
Gate-Source Voltage	V_{GSS}	± 20		V
Continuous Drain Current	$I_D (T_C=25^\circ C)$	17	-12	A

BRCS4614YAQ

Rev.A May.-2023



DATA SHEET

Parameter	Symbol	Test Conditions	Min	Typ	Max	Unit
Drain-Source Breakdown Voltage	BV_{DSS}	$V_{GS}=0V$ $I_D=250\mu A$	40	45		V
Zero Gate Voltage Drain Current	I_{DSS}	$V_{DS}=40V$ $V_{GS}=0V$			1.0	μA
Gate-Body leakage current	I_{GSS}	$V_{GS}=\pm 20V$ $V_{DS}=0V$			± 100	

N- / N-CHANNEL Electrical Characteristic Curve

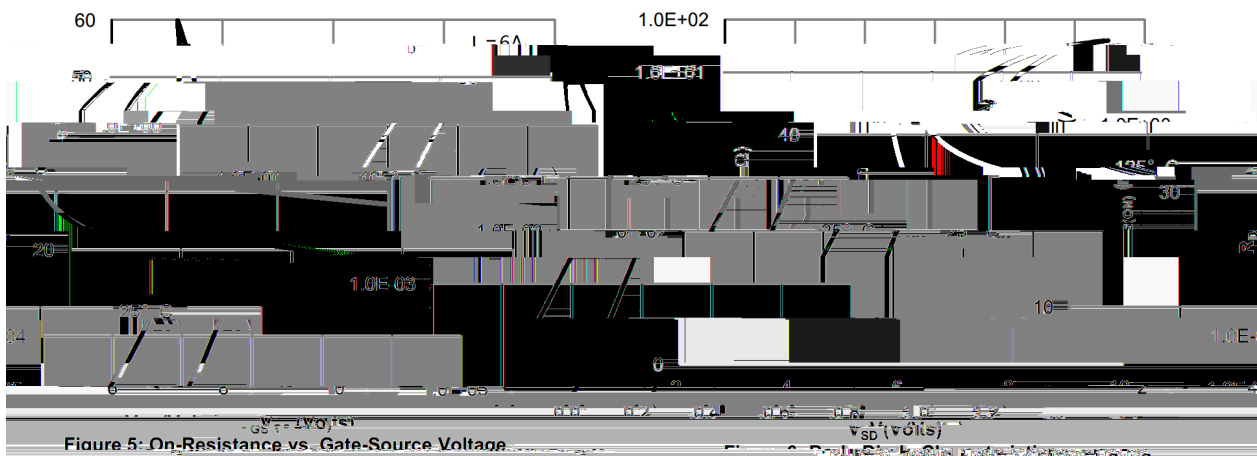
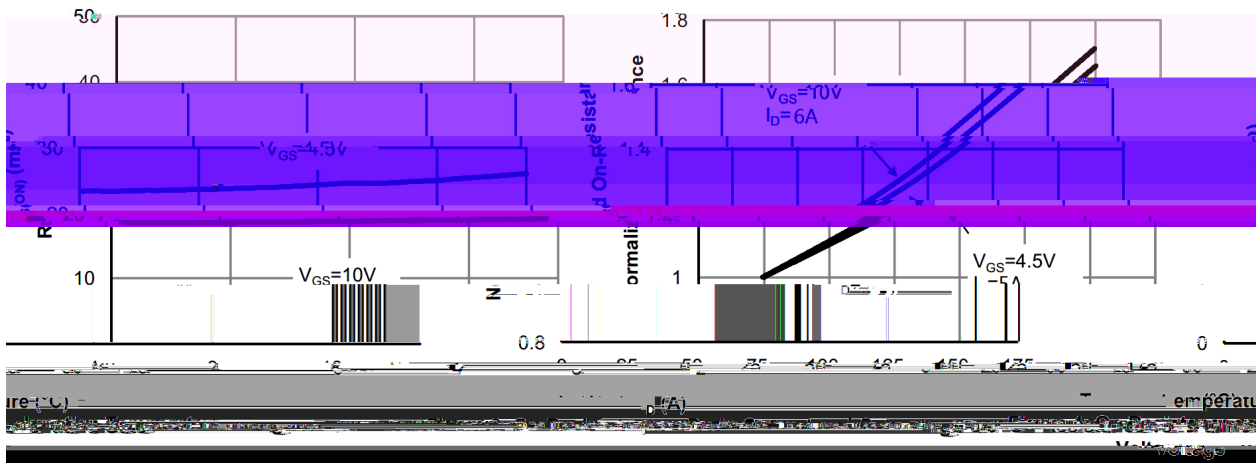
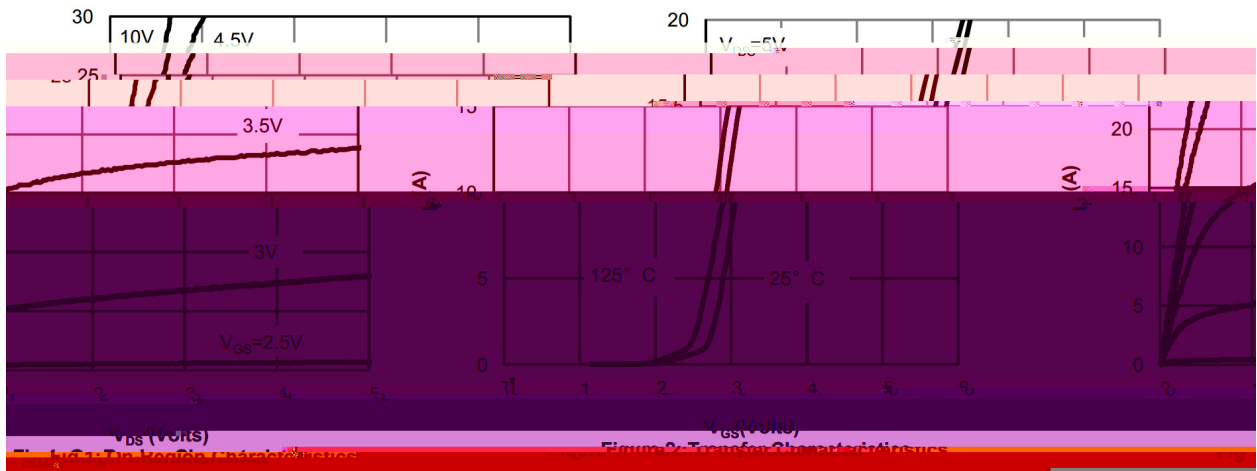

BRCS4614YAQ
Rev.A May.-2023



DATA SHEET



BRCS4614YAQ

Rev.A May.-2023



DATA SHEET

Parameter	Symbol	Test Conditions	Min	Typ	Max	Unit
Drain-Source Breakdown Voltage	BV_{DSS}	$V_{GS}=0V$ $I_D=-250\mu A$	-40	-46		V
Zero Gate Voltage Drain Current	I_{DSS}	$V_{DS}=-40V$ $V_{GS}=0V$ <small>(I_{DSS})</small>			-1.0	μA

Gate-Body leakage c-.18 Tc.0w ~~BRCS~~ $\pm 2V$

P- / P-CHANNEL Electrical Characteristic Curve

P- / P-CHANNEL Electrical Characteristic Curve

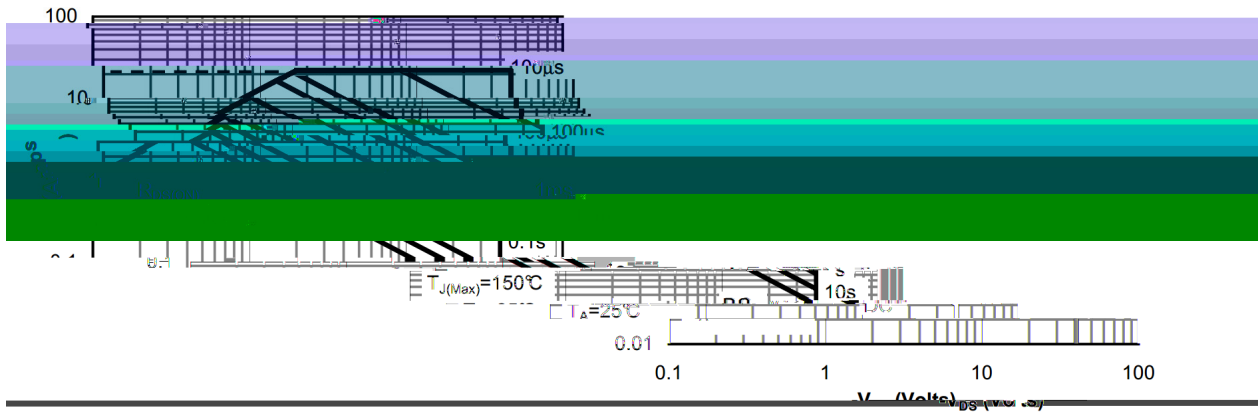
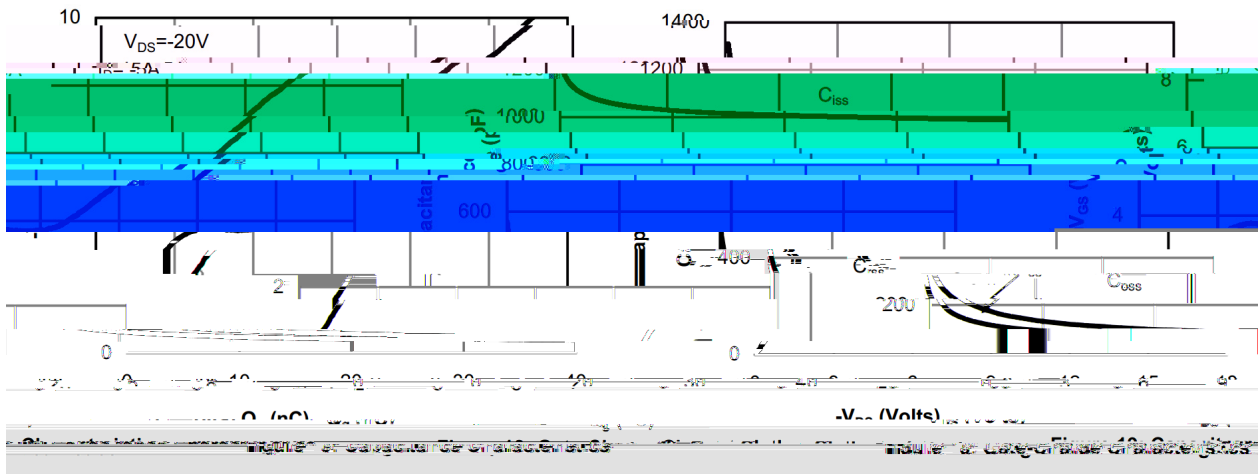
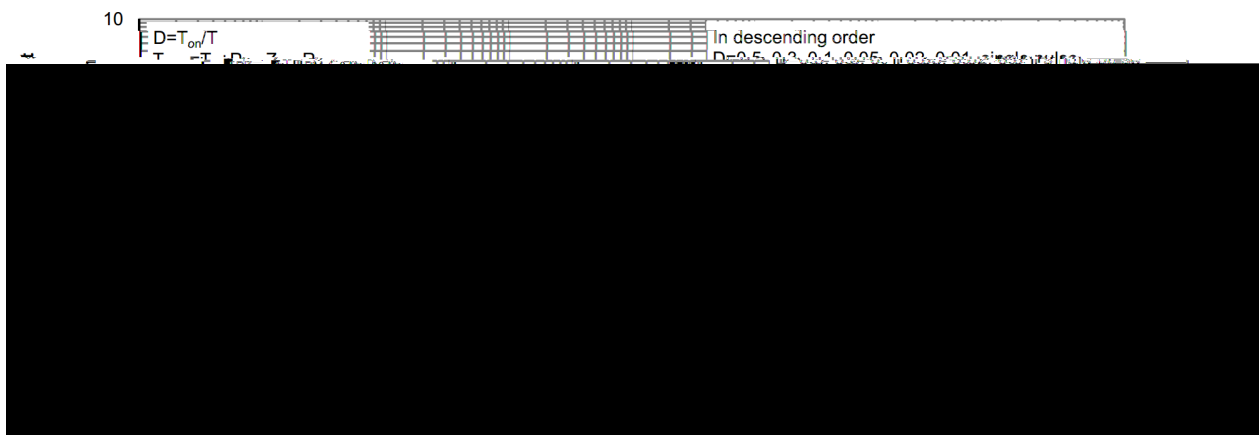

Figure 20: Maximum Forward Biased Safe Operating Area



/ Package Dimensions

PDFN3X3-8L

Unit:mm

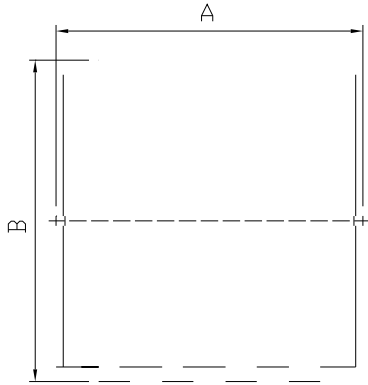

Dimensions In Millimeterer			
Symbol	MIN	TYP	MAX
A	3.20	3.30	3.40
A1	3.10	3.15	3.20
B	3.20	3.30	3.40
B1	2.95	3.00	3.05

Rev.00 202011

/ Marking Instructions

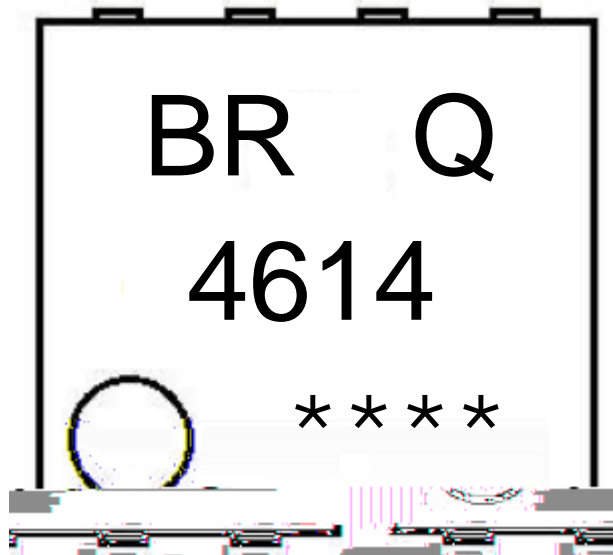

BR

Q

4614

Note:

BR: Company Code

Q: Automobile halogen-free product Code

4614: Product Type Code

****: Lot No. Code, code change with Lot No

