

--	--	--	--	--

# BR2SD1815Q

Rev.A Apr.-2022



DATA SHEET

## / Descriptions

TO-252          NPN

Silicon NPN transistor in a TO-252 Plastic Package.

## / Features

AEC-Q101

Qualified to AEC-Q101 Standards for High Reliability, HF Product.

## / Applications

Relay drivers,high-speed inverters,converters,and other general high-current switching applications, Meet the stringent requirements of automotive applications.

## / Equivalent Circuit

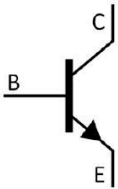

## / Pinning

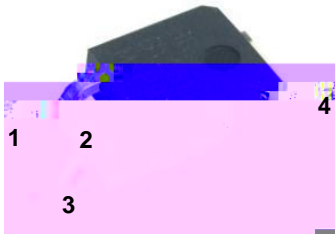

PIN1 Base          PIN 2,4 Collector          PIN 3 Emitter

## / $h_{FE}$ Classifications & Marking

$h_{FE}$ Classifications Symbol	Q	R	S	T
$h_{FE}$ Range	70-140	100-200	140-280	200-400

# BR2SD1815Q

Rev.A Apr.-2022



DATA SHEET

Parameter	Symbol	Rating	Unit
Collector to Base Voltage	$V_{CBO}$	120	V
Collector to Emitter Voltage	$V_{CEO}$	100	V
Emitter to Base Voltage	$V_{EBO}$	6	V
Collector Current - Continuous	$I_C$	3	A
Collector Current – Continuous(Pulse)	$I_{CP}$	6	A
Collector Power Dissipation	$P_C$	1	W
Collector Power Dissipation	$P_C(T_C=25^\circ\text{C})$	10	W
Junction Temperature	$T_j$	150	$^\circ\text{C}$
Storage Temperature Range	$T_{stg}$	-55~150	$^\circ\text{C}$

Parameter	Symbol	Test Conditions	Min	Typ	Max	Unit
Collector to Base Breakdown Voltage	$V_{CBO}$	$I_C=10\mu\text{A}$ $I_E=0$	120			V
Collector to Emitter Breakdown Voltage	$V_{CEO}$	$I_C=1\text{mA}$ $I_B=0$	100			V
Emitter to Base Breakdown Voltage	$V_{EBO}$	I				



**/ Package Dimensions**

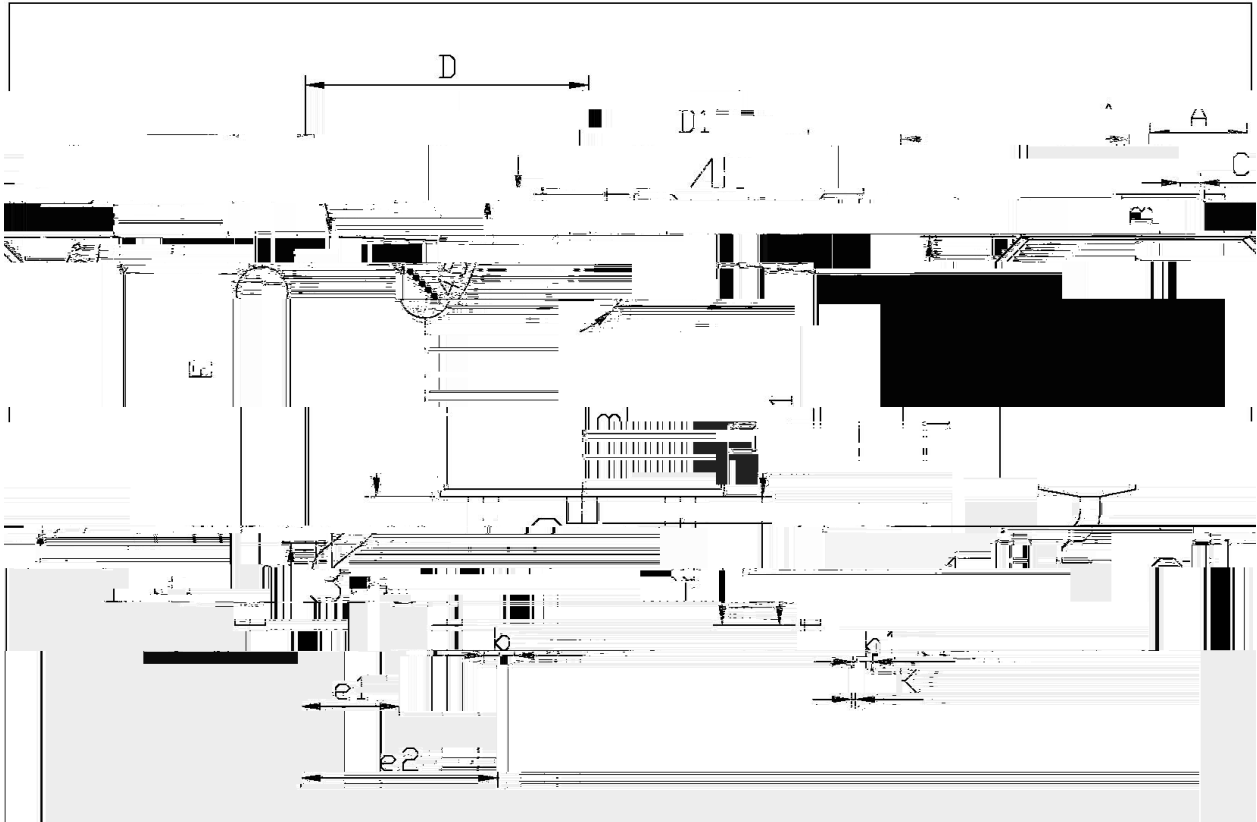

单位: mm

Dimensions in millimeters Symbol	Dimensions in millimeters		Dimensions in inches	
	Min	Max	Min	Max
$e_1$	6.05	6.25	0.238	0.248
$e_2$	4.43	4.73	0.174	0.186
$b$	0.95	1.05	0.037	0.041
$D$	6.45	6.75	0.254	0.268
$D_1$	5.10	5.50	0.201	0.217

T0-252

/ Marking Instructions

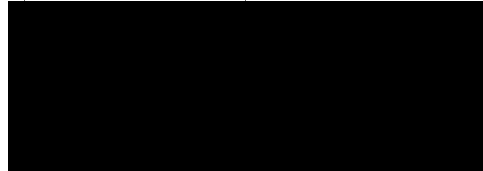
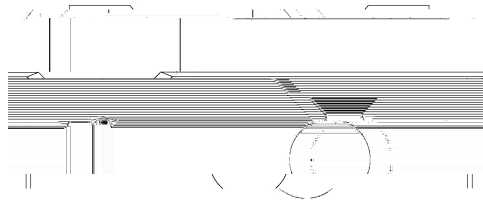

说明：

BR： 为公司

Q： 为汽车无卤产品标识

D1815： 为型号

R： 为  $h_{FE}$  分档

\*\*\*\*： 为生产批号 ， 随生产批号变化

Note:

BR: Company Code

Q: Automobile halogen-free product Code

D1815: Product Type.

R:  $h_{FE}$  Classifications Symbol

\*\*\*\*: Lot No

