

# 7805

Rev.H Jun.-2024

5 é / P

:5 .> // x 9 ² ... ~ož Voltage Regulator in a TO-92 Plastic Package.

α a / 6

€ 19 ² ... ~k y ß v ä S' Ä — ½ ' y ? è ' ò ož  
3-Terminal regulators ,output current up to 100 mA, internal thermal overload protection and short-circuit limiting.

Đ ÷ / A

9 ² ... ~ož  
Voltage Regulator.

Ã W ] Ô . / € Đ Ô . / 7805



• Ū - æ / 8

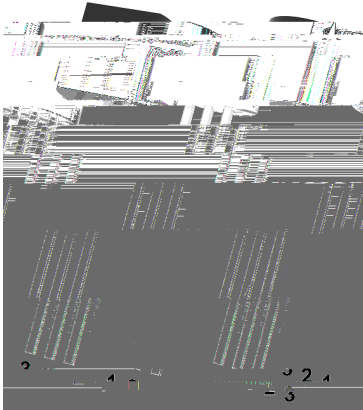

PIN1 y IN

PIN 2 y GND

PIN 3 y OUT

, M V / 9

• - ~ a ø ož  
See Marking Instructions.

Ã a ? d / 25 ; )

@ f Parameter	... Z Symbol	f › Rating	% y Unit
Input voltage	V <sub>I</sub>	30	V
Output current	I <sub>O</sub>	100	mA
Operating Temperature Range	T <sub>OPR</sub>	-40 125	
Power Dissipation	P <sub>D</sub>	500	mW
Storage temperature range	T <sub>stg</sub>	-65 150	

Ô4ì x ? d / 25 ; g M10,40A g

@ f Parameter	... Z Symbol	y j Ú ^ Test Conditions	Â 4 › Min	Á ° › Typ	Â Ý › Max	% y Unit
Output voltage	V <sub>O</sub>	I <sub>O</sub> Ú40mA T <sub>j</sub> =25	4.80	5.0	5.2	V
		I <sub>O</sub> =1mA to 40mA V <sub>I</sub> =7V to 20V	4.75	5.0	5.25	V
		I <sub>O</sub> =1mA to 70mA V <sub>I</sub> =10V	4.75	5.0	5.25	V
Input regulation	. V <sub>O</sub>	V <sub>I</sub> =7V to 20V T <sub>j</sub> =25		32	150	mV
		V <sub>I</sub> =8V to 20V T <sub>j</sub> =25		26	100	mV
Output regulation	. V <sub>O</sub>	I <sub>O</sub> =1mA to 100mA T <sub>j</sub> =25		15	60	mV
		I <sub>O</sub> =1mA to 40 mA T <sub>j</sub> =25		8	30	mV
Ripple rejection	RR	V <sub>I</sub> =8V to 18V f=120Hz T <sub>j</sub> =25	41	49		dB
Output noise voltage	V <sub>N</sub>	f=10Hz-100KHz T <sub>j</sub> =25		42		V
Dropout voltage	V <sub>D</sub>	T <sub>j</sub> =25		1.7		V
Bias current	I <sub>Q</sub>	T <sub>j</sub> =25		3.8	6	mA
		T <sub>j</sub> =125			5.5	mA
Bias current change	. I <sub>Q</sub>	V <sub>I</sub> =8V to 20V			1.5	mA
		I <sub>O</sub> =1mA to 40mA			0.1	mA

Ô ? d • Ž ϕ /

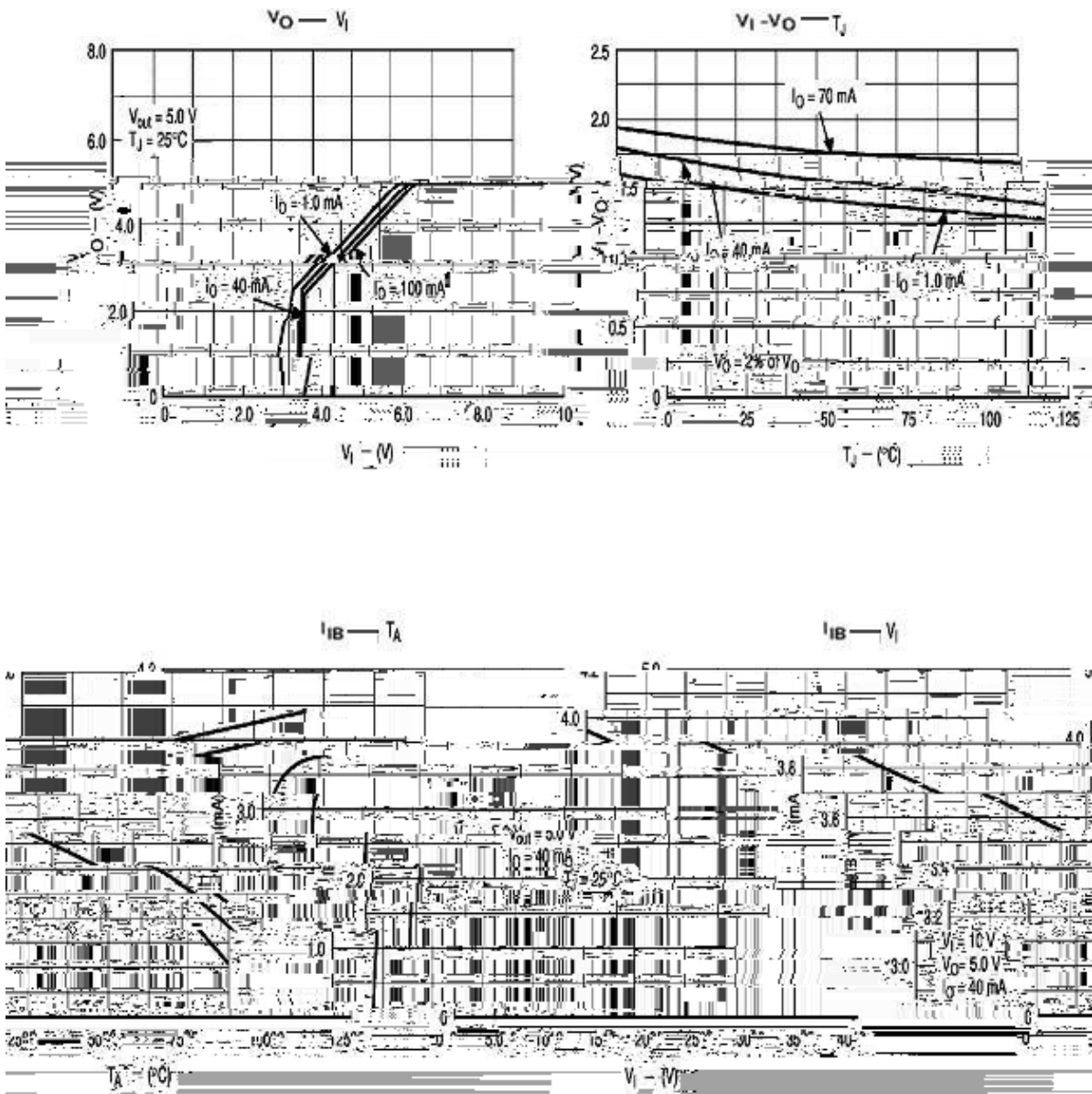

7805

Rev.H Jun.-2024

Ø □ = ) φ /

T0-92

Unit: mm

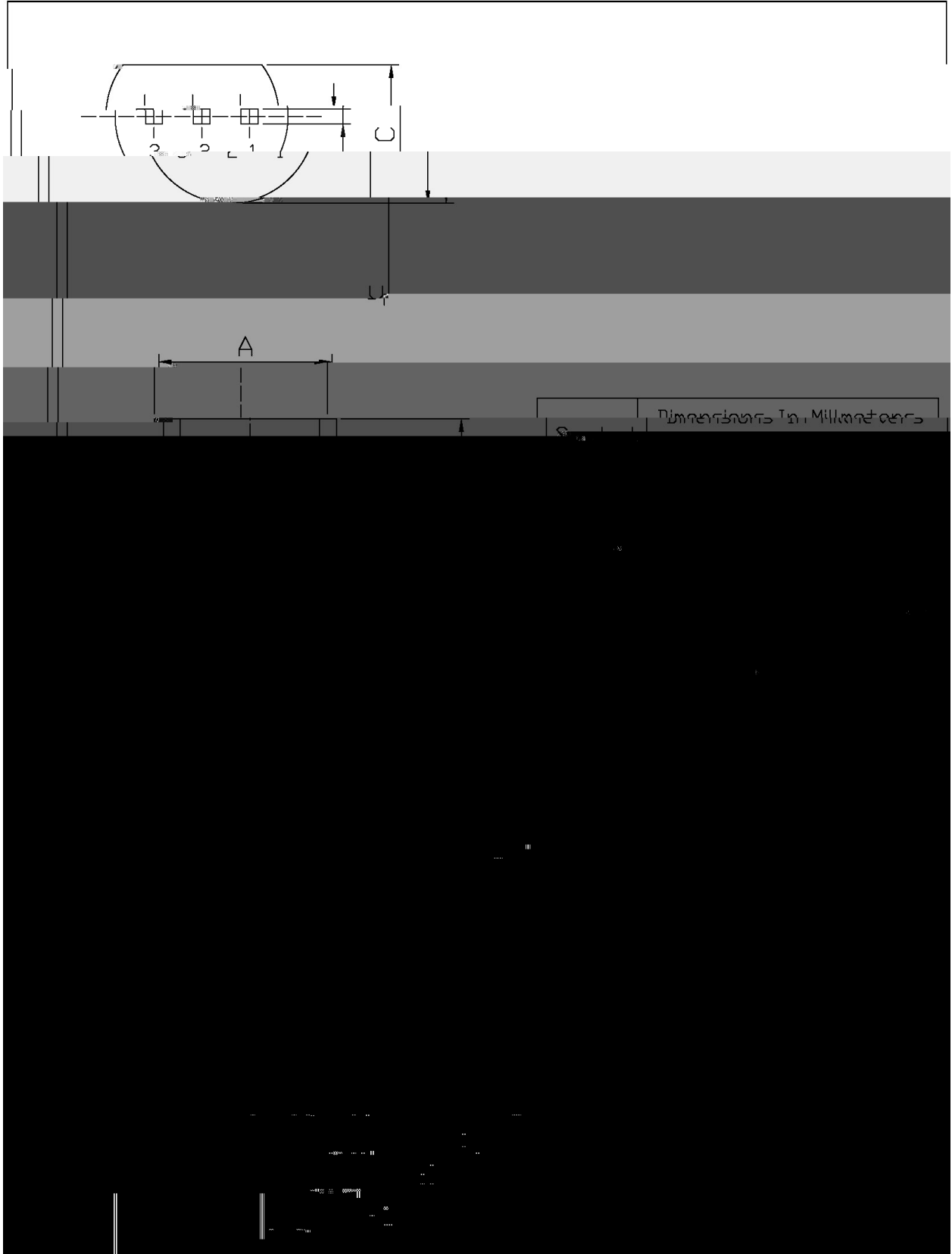

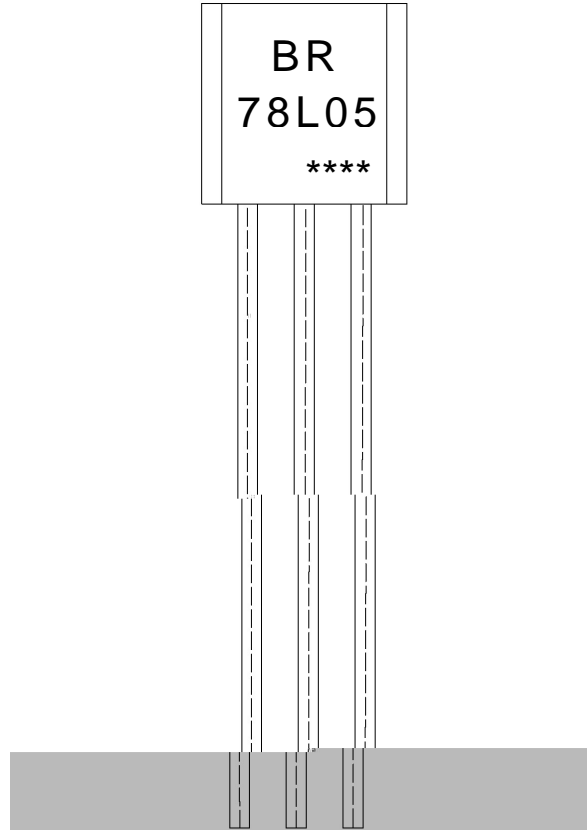

<sup>a</sup> ϕ y  
 ( 8 y                    , [ W A  
      2 y                    D } ° Z  
        y                    ÿ D Z W A k š ÿ D Z J

Note:

BR:                    Company Code

78L05:                Product Type

\*\*\*\*:                    Lot No. Code, code change with Lot No

G PD t... • Ž ϕ ( x / ) / ~~4005~~

<sup>a</sup> ϕ y

1o• Ä ½ “ † 25 ½150 - k ž • 60 ½90sec;

2o• Q › “ † 255 r5 - k ž • 4 Ò 5 r0.5sec;

3o•D N ò i Ò 0 , † 2 ½10 - /sec.

Note:

1.Preheating:25~150 - , Time:60~90sec.

2.Peak Temp.:255 r5 - , Duration:5 r0.5sec.

3. Cooling Speed: 2~10 - /sec.

ÂD /Cã p<sup>-</sup> » ] / ~~4005~~

“ † y 270 r5 -

ž • y 10 r1 sec.

Temp.:270±5

Time:10±1 sec

G P á / ~~4005~~

• ^ x / BULK