

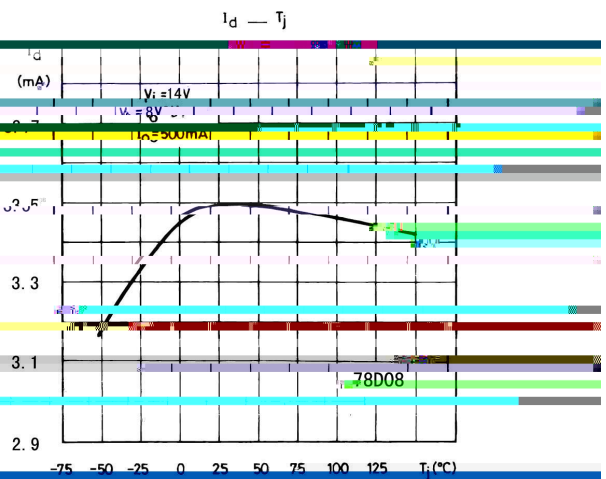

Parameter	Symbol	Rating	Unit
Input voltage	$V_i$	35	V
Thermal Resistance Junction-ambient	$R_{JA}$	65	/W
Thermal Resistance Junction-case	$R_{JC}$	5.0	/W
Operating Junction Temperature Range	$T_{OPR}$	0 125	
Storage temperature range	$T_{stg}$	-65 150	

Parameter	Symbol	Test Conditions	Min	Typ	Max	Unit
Output voltage	$V_o$	$T_j=25$	7.7	8.0	8.3	V
		$V_i=10.5V-25V$ $I_o=5mA-1A$ $P_o$ 15W	7.6	8.0	8.4	V
Load Regulation	$V_o$	$T_j=25$ $I_o=5.0mA-1.5A$			160	mV
		$T_j=25$ $I_o=250mA-750mA$			80	mV
Line regulation	$V_o$	$T_j=25$				

/ Electrical Characteristic Curve

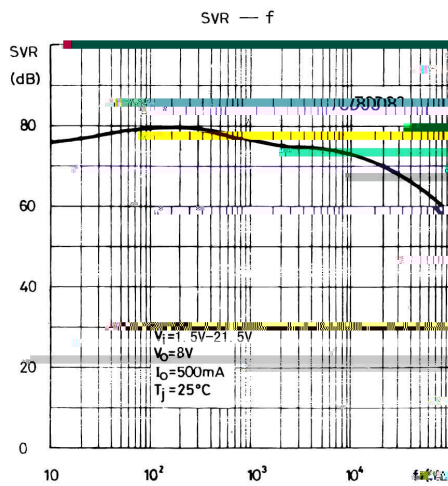
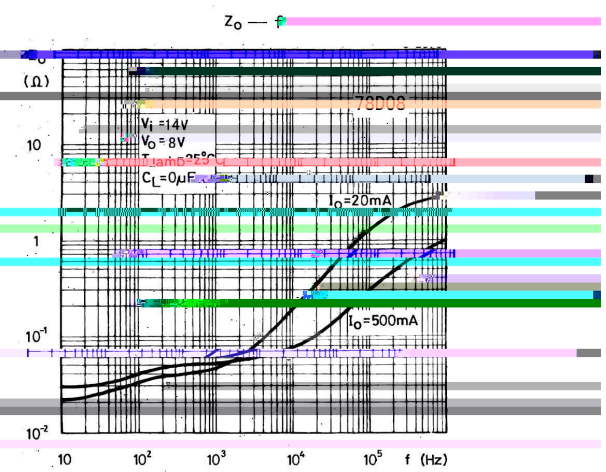
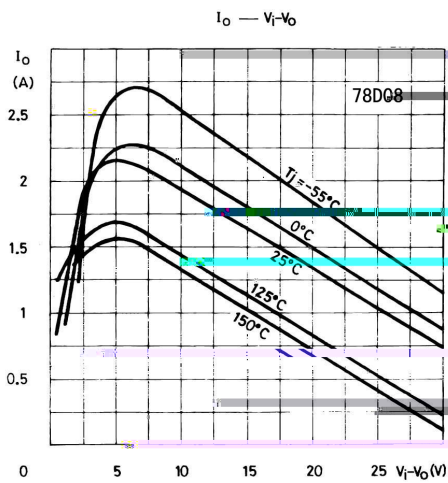
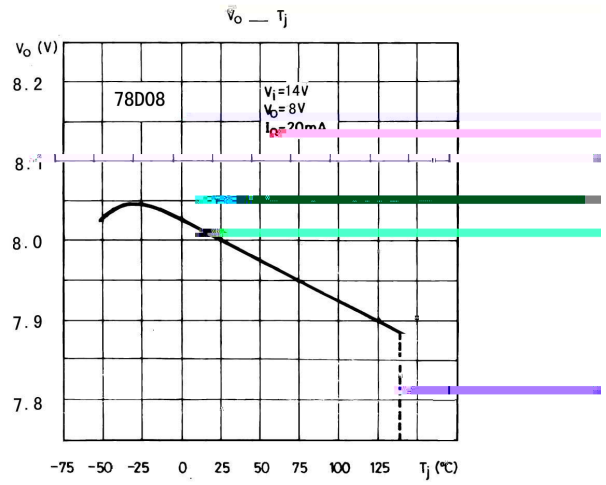
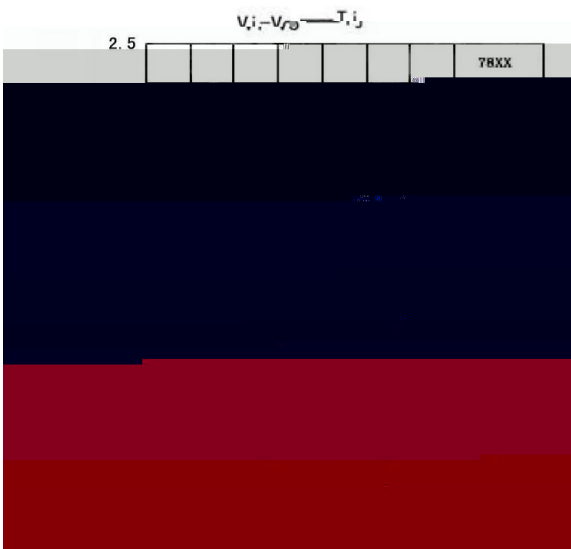

/ Package Dimensions

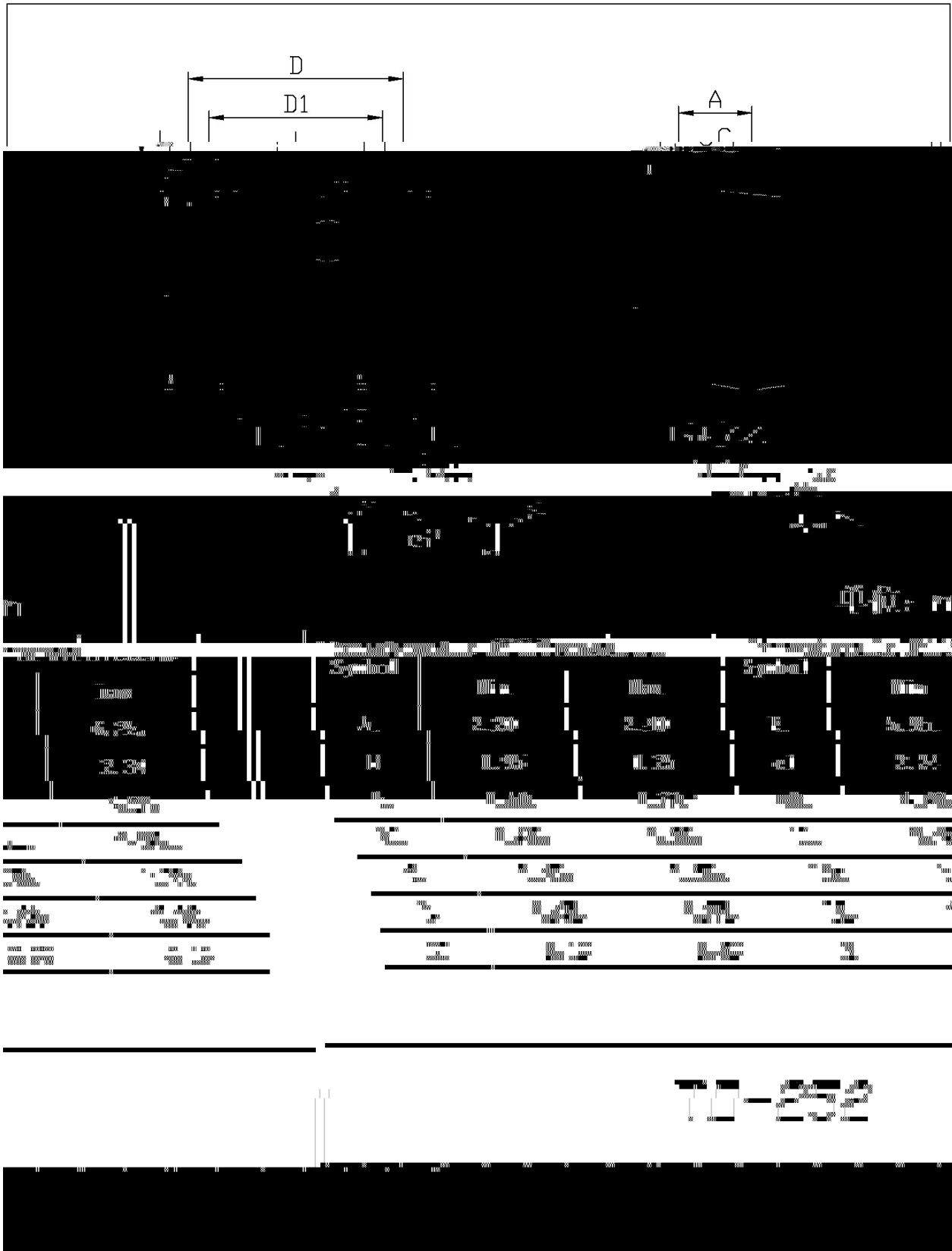

/ Marking Instructions

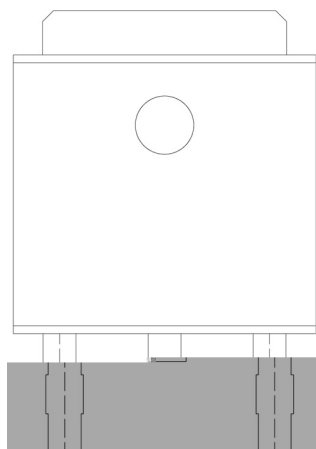

BR

78D08

\*\*\*\*

Note:

BR: Company Code.

78D08: Product Type.

\*\*\*\*: Lot No. Code, code change with Lot No.

**78D08**  
Rev.G Dec.-2018