

**/ Descriptions**

KF \$ , ) E GE Silicon NPN transistor in a TO-252 Plastic Package.

**/ Features**

High breakdown voltage ,Low collector output capacitance ,High transition frequency.

**/ Applications**

# #  
Power supplies, relay drivers, lamp drivers, and automotive wiring.

**/ Equivalent Circuit**

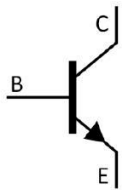

**/ Pinning**

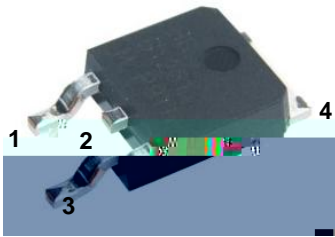

PIN1 Base PIN 2,4 Collector PIN 3 Emitter

**/ h<sub>FE</sub> Classifications & Marking**

h <sub>FE</sub> Classifications Symbol	P	Q	R
h <sub>FE</sub> Range	82 180	120 270	180 390

Parameter	Symbol	Rating	Unit
Collector to Base Voltage	$V_{CBO}$	120	V
Collector to Emitter Voltage	$V_{CEO}$	120	V
Emitter to Base Voltage	$V_{EBO}$	5	V
Collector Current - Continuous	$I_C$	2	A
Collector Current – Continuous(Pulse)	$I_{CP}$	3	A
Collector Power Dissipation	$P_C$	1.75	W
Junction Temperature	$T_j$	150	
Storage Temperature Range	$T_s$	-55 to 150	°C

/ Electrical Characteristic Curve

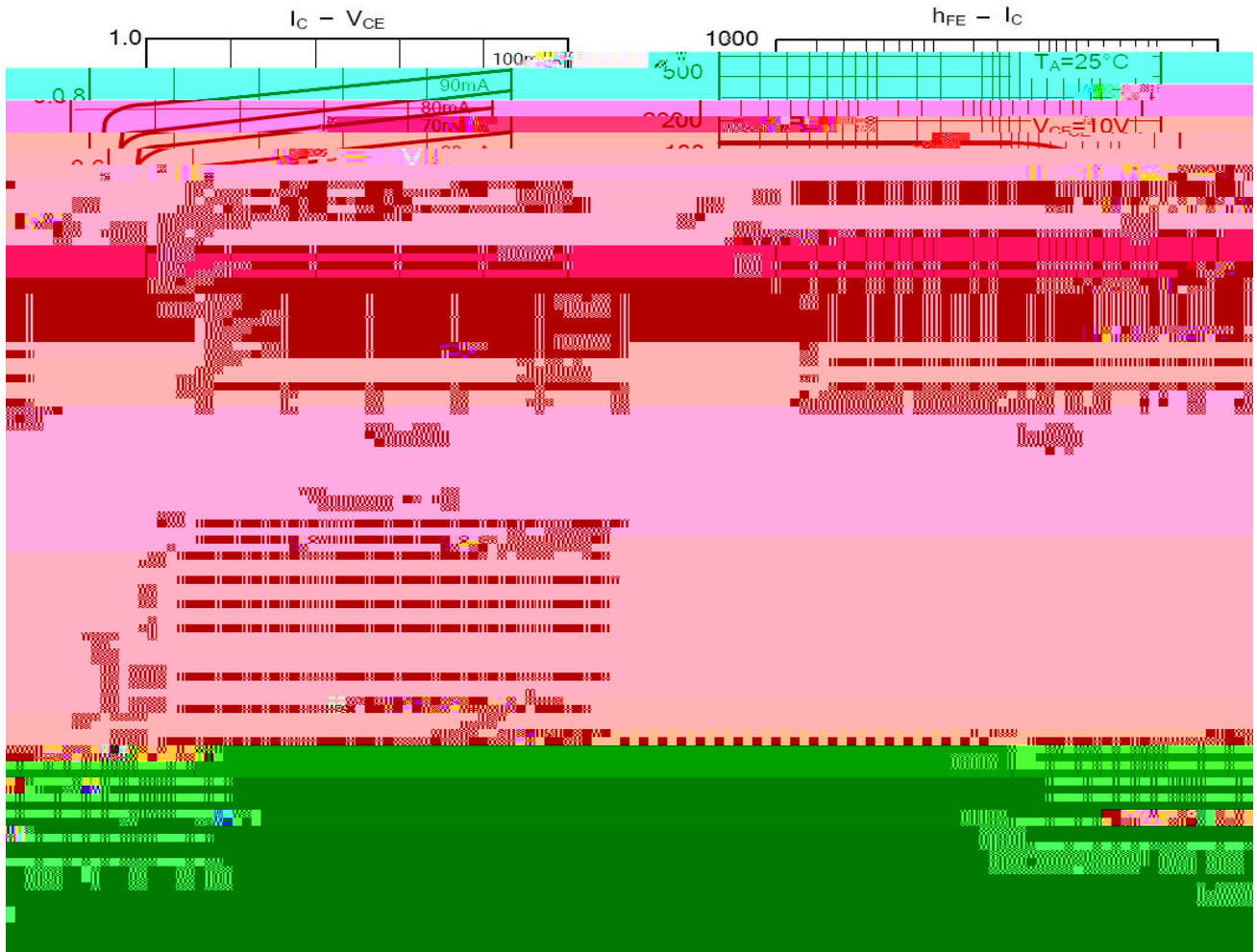

/ Package Dimensions

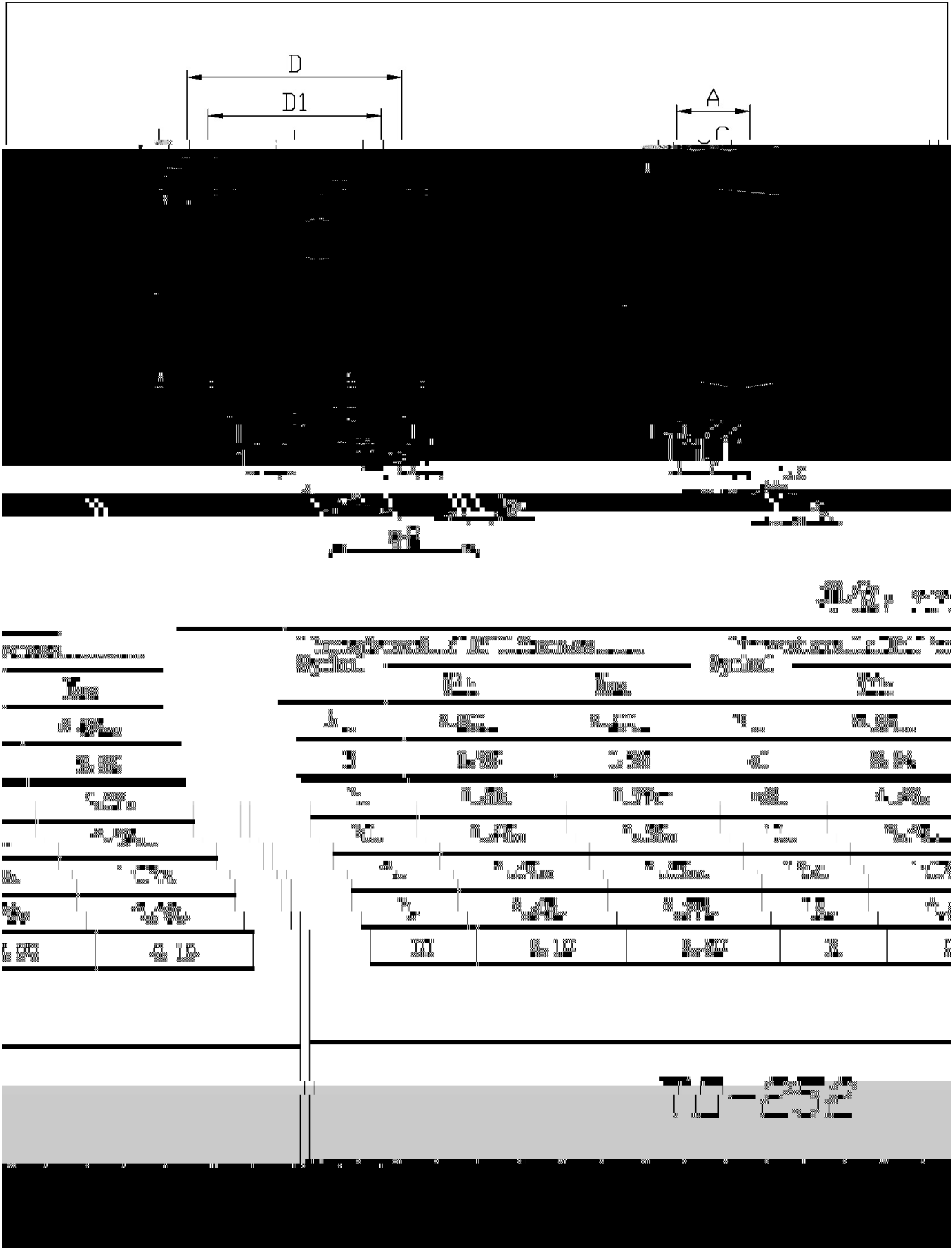

/ Marking Instructions

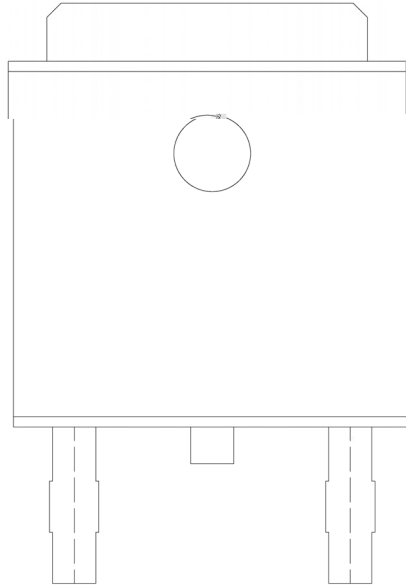

BR

; ( / , . ;

G1                       $h_{FE}$

!!!!

Note:

BR:                      Company Code

D1857D:                Product Type.

P:                         $h_{FE}$  Classifications Symbol

\*\*\*\*.

**2SD1857D**  
Rev.E May.-2016

**DATA SHEET**