

**/ Descriptions**

KF (\$) - = E GE Silicon NPN transistor in a TO-126F Plastic Package.

**/ Features**

)J8. (,  
Complementary pair with 2SA715.

**/ Applications**

Low frequency power amplifier.

**/ Equivalent Circuit**

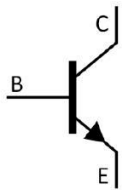

**/ Pinning**

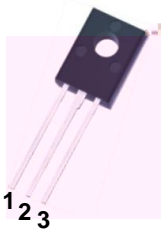

PIN1 Emitter      PIN 2 Collector      PIN 3 Base

**/ h<sub>FE</sub> Classifications & Marking**

h <sub>FE</sub> Classifications Symbol	B	C	D
h <sub>FE</sub> Range	60 120	100 200	160 320

Parameter	Symbol	Rating	Unit
Collector to Base Voltage	$V_{CBO}$	35	V

**/ Electrical Characteristic Curve**

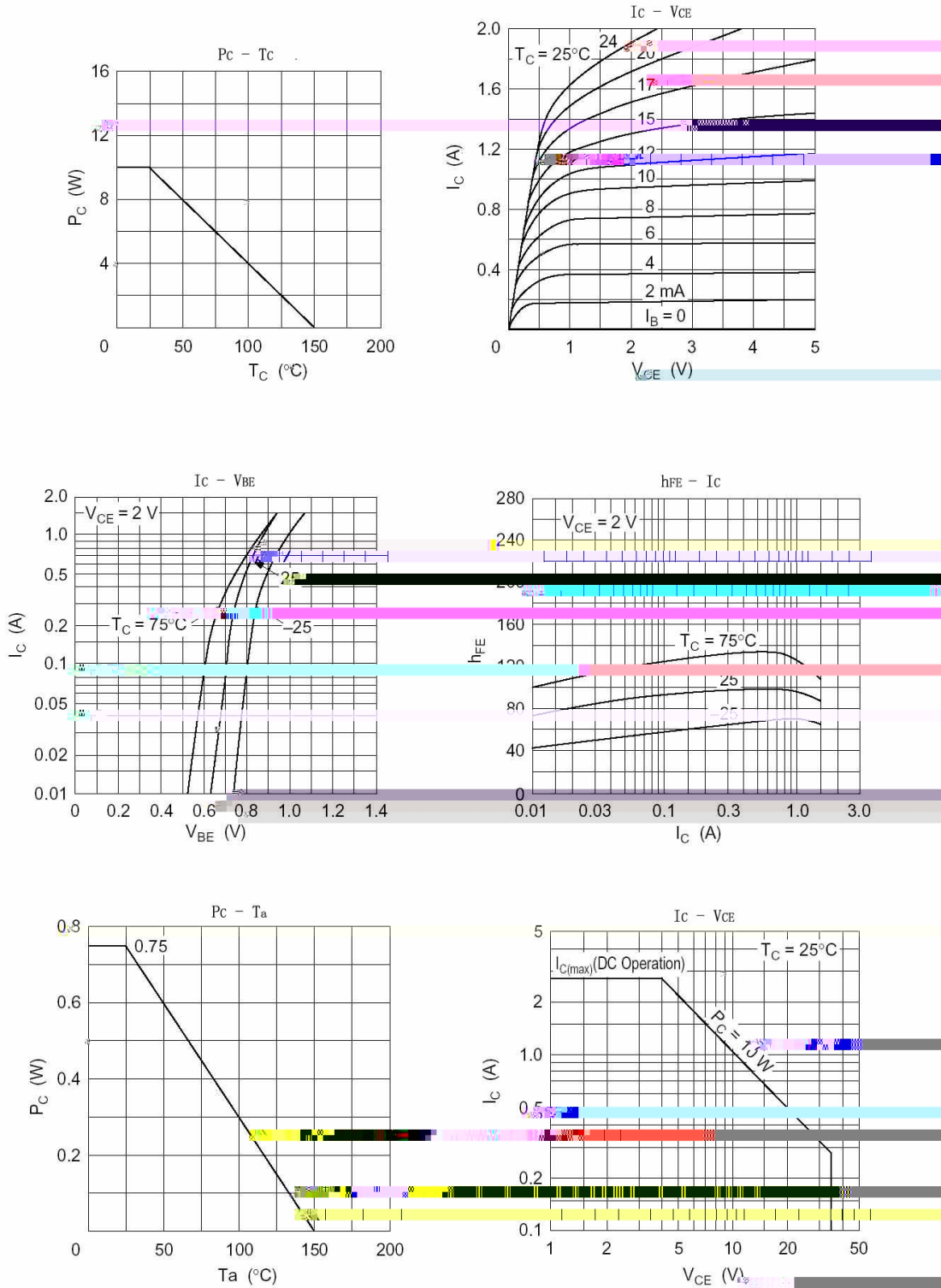

/ Package Dimensions

TU-126F

单位: mm

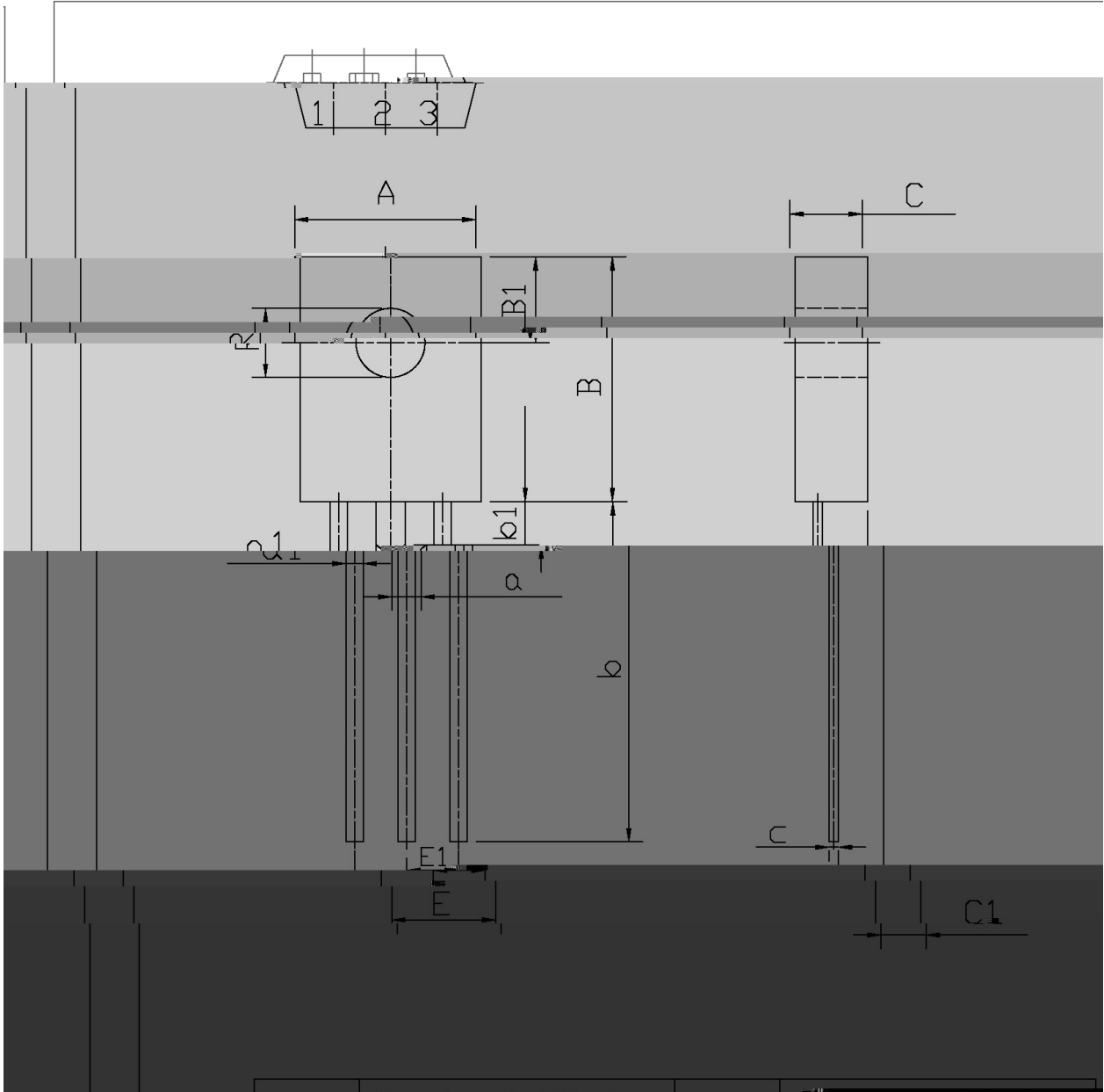

Symbol	Min	Max	Symbol	Min	Max
A	7.8	8.2	a	0.6	0.6

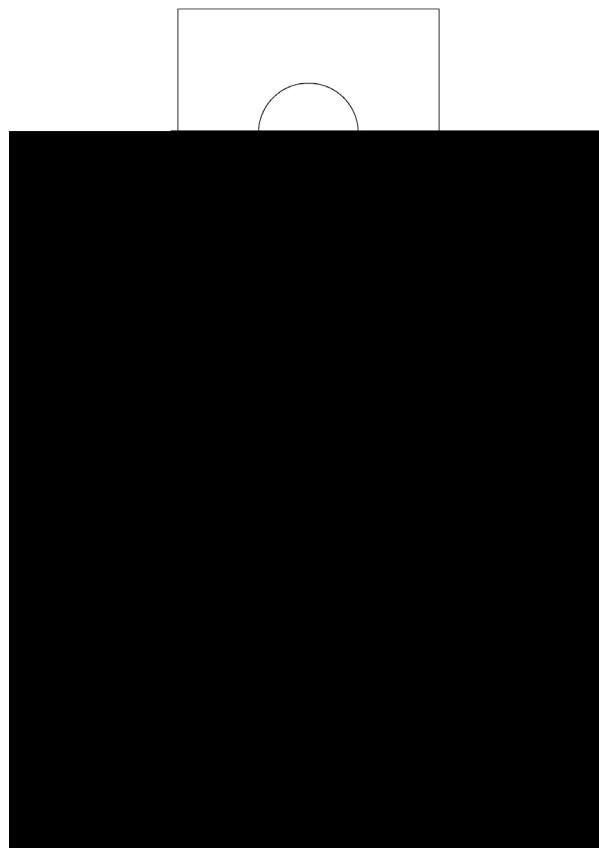

( ) / Temperature Profile for Dip Soldering(Pb-Free)

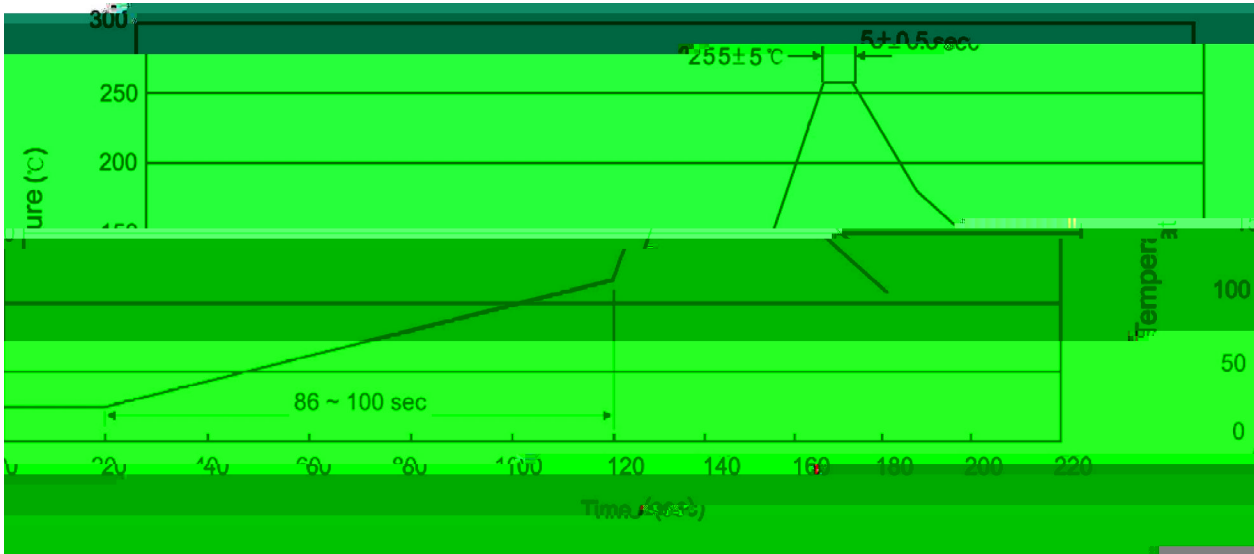

Note:

- |   |        |     |     |          |   |
|---|--------|-----|-----|----------|---|
| 1 | 25     | 150 | 60  | 90sec;   | 1.Preheating:25~150 , Time:60~90sec.      |
| 2 | 255..5 |     | 5.. | 0.5sec;  | 2.Peak Temp.:255..5 , Duration:5..0.5sec. |
| 3 |        |     | 2   | 10 /sec. | 3. Cooling Speed: 2~10 /sec.              |

/ Resistance to Soldering Heat Test Conditions

270..5                      10...1 sec.                      Temp.:270±5                      Time:10±1 sec

/ Packaging SPEC.

/ BULK

Package Type	Units					Dimension (unit mm <sup>3</sup> )		
	Units/Tube	Tubes/Inner Box	Units/Inner Box	Inner Boxes/Outer Box	Units/Outer Box	Tube	Inner Box	Outer Box
TO-126/F	500	6	3,000	5	15,000	135×190	237×172×102	560×245×195

/ TUBE

Package Type	Units					Dimension (unit mm <sup>3</sup> )		
	Units/Tube	Tubes/Inner Box	Units/Inner Box	Inner Boxes/Outer Box	Units/Outer Box	Tube	Inner Box	Outer Box
TO-126/F	65	26	1,690	5	8,450	532×31×5.6	555×164×50	575×290×180